



## **The Global 1.5 Portable Restroom with PT-505 Tank Assembly Instructions**



The Most Rugged Portable Restroom and Parts in the Industry!



**CAUTION: TOILET SHOULD BE MOVED IN THE DIRECTION OF THE SKID RUNNERS, DRAGGING AGAINST THE RUNNERS COULD CAUSE DAMAGE NOT COVERED BY MANUFACTURERS WARRANTY.**

**Tools Needed:**

1. Drill / Driver
2. Rivet Gun
3. Phillips Screw Driver
4. Ratchet
5. 7/16" Deep Well socket
6. 13/64 Drill Bit

**Bill of Material:**

<b>Item</b>	<b>Hampel Item Number</b>	<b>Description</b>	<b>Qty</b>
1	PT-470-ASMB	Base, 1.5 toilet assembled	1
2	PT-505	Toilet Tank with Seat	1
3	GBL-101-(COLOR)-1	Global front	1
4	GBL-200-(COLOR)-2	Global domestic side smooth	3
5	PT-250-(COLOR)	Half panel, 1.5 toilet global	2
6	PT-301-NAT	Roof, 1.5 natural	1
7	PT-HDWE-030-1*	Heavy Duty Extrusion	4
8	PT-730-(COLOR)-2	Twin Sheet Urinal	1
9	PT-710-(COLOR)-1	Twin Sheet 3 Roll Paper Holder	1
10	PT-HDWE-024	Rod, 3-roll paper holder	1
11	PT-720-(COLOR)-1	Twin Sheet Vent Tube	1
12	PT-750-(COLOR)-1	Twin Sheet Shelf	1
13	SHD-HDWE-020K	Rivet, Bulbex, Large Flange Kit	1
14	PT-200	Handle, Toilet – Gray Blow Molded	1
15	PT-HDWE-018K	Door Handle Screw Kit	1
16	CC-HDWE-019K	Door Handle Lock Nut Kit	1
17	SHD-HDWE-013K	Door Handle Washer Kit	1
18	PT-HDWE-016K	Rivet, Bulbex, 3/16" x 1", Kit	1
19	PT-HDWE-004	Lock, Brass Padlock, Yeti	1
20	GBL-HDWE-012-1	Vent Screen, Global	9
21	GNB-HDWE-006K	Rivet, Screen, 3/16" x 1/2", Kit	1
22	SHD-HDWE-004K	Washer, Aluminum Backup, Kit	1
23	SHD-HDWE-018K	Rivet, Large Flange Kit	1
24	PT-HDWE-217	Coat Hook	1
25	PT-HDWE-221K	Rivet, Bulbex, Small Flange Kit	1



**Step 15:**

Assemble coat hook to doorframe.

- a) Assemble the PT-HDWE-217 coat hook to the door frame using a PT-HDWE-221, Rivet.  
**See Fig 16 and 17**

**Notes:**

- 1). There is a dimple location on the doorframe for the rivet location.
- 2). Pre-drilled hole is required...use 13/64" drill bit



**Figure 16**

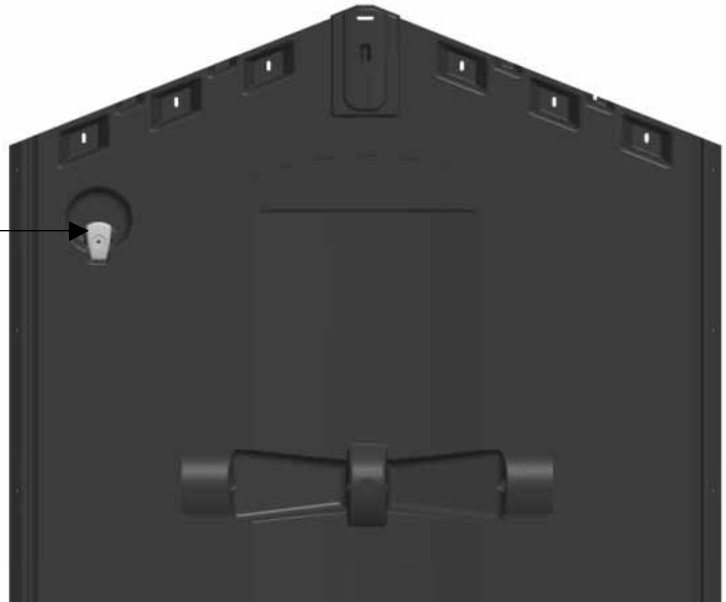
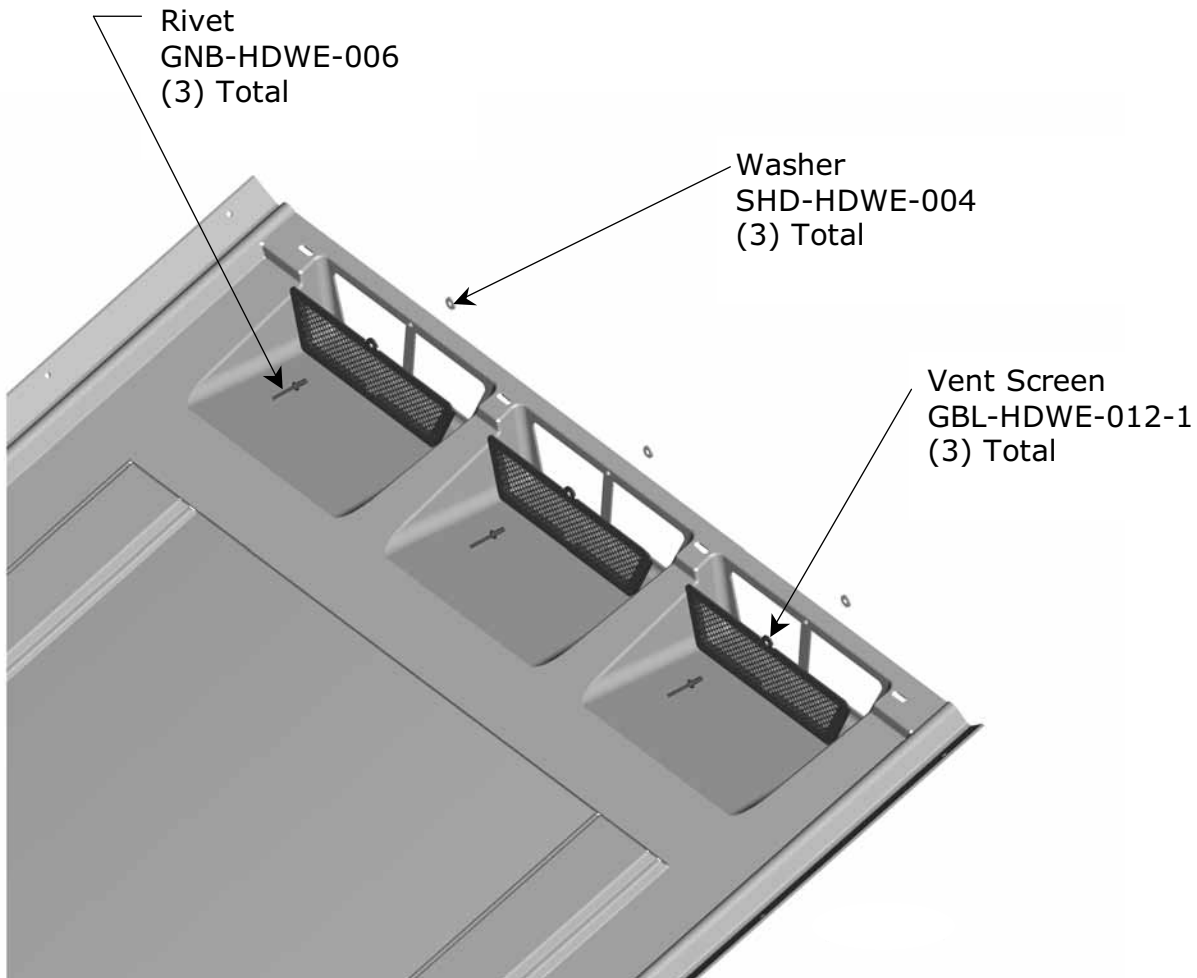

**Figure 17**



**Step 1:**

- A. Assemble Screens to Side Panel using:
  - a. (9) Small Rivets: GNB-HDWE-006
  - b. (9) Back-up Washers SHD-HDWE-004
  - c. (9) Vent Screens: GBL-HDWE-012-1
  
- B. Repeat for all (3) Side Panels (Vent screens should already be in half panels).

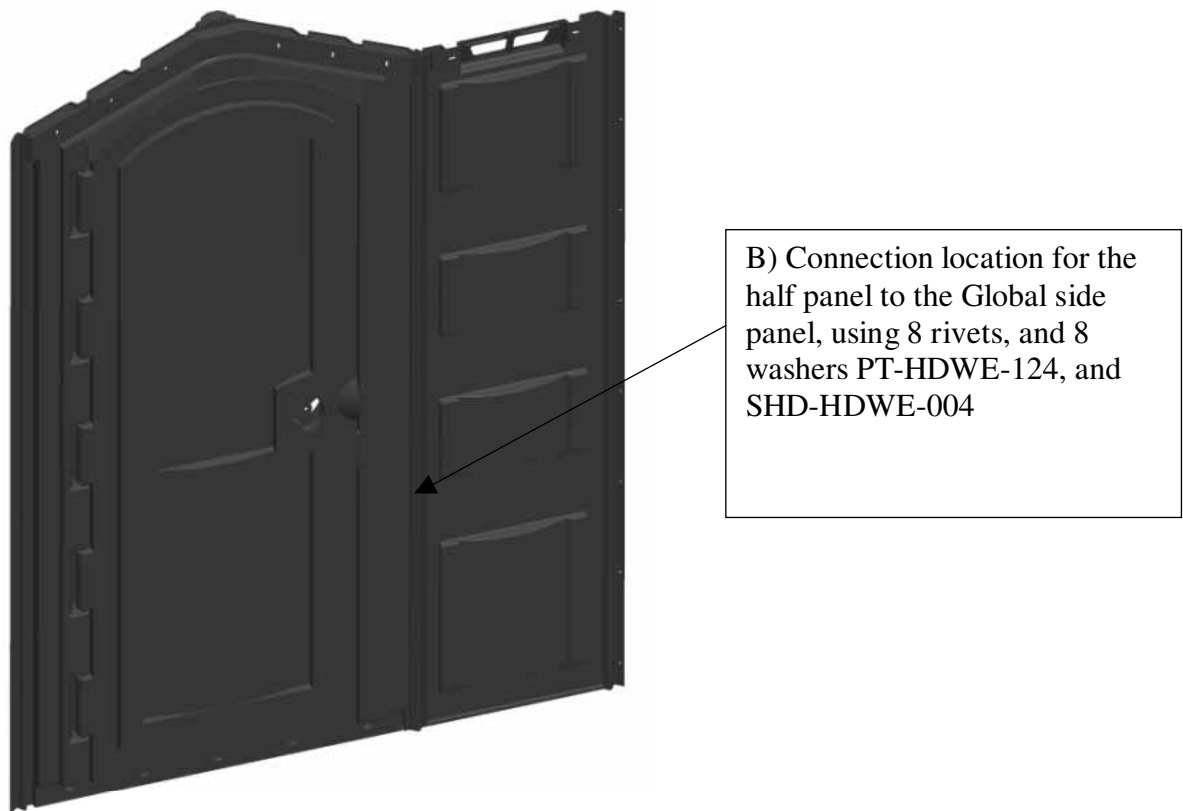

**Figure 1**



**Step 2:**

- A. Assemble the front half panel by sliding it down through the flange of the doorframe.
- B. Use the PT-HDWE-124 rivets, and SHD-HDWE-004 washers to fasten the doorframe to the half panel.



**Figure 2**



**Step 3:**

- A. Assemble the left Global side panel using 1) PT-HDWE-030-1 heavy-duty extrusion. Do this by sliding the extrusion down from the top.

By sliding down from the top, connect the Global side panel to the doorframe with 1) heavy-duty extrusion.



**Figure 3**



**Step 4:**

- A. Connect the back Global side panel to the back half panel by sliding it down from the top in the same manner you assembled the front. Use PT-HDWE-124 rivets, and SHD-HDWE-004 washers to fasten the two panels together.
- B. Once the back panel, and the back half panel are connected, assemble the two panels to the left Global side panel using the PT-HDWE-030-1 heavy-duty extrusion.

A) Connection location for the half panel to the Global side panel, using 8 rivets, and 8 washers PT-HDWE-124, and SHD-HDWE-004.



**Note:** Assembling, and fastening these two panels together before connecting to the left side panel with the extrusion, may help make assembly easier.

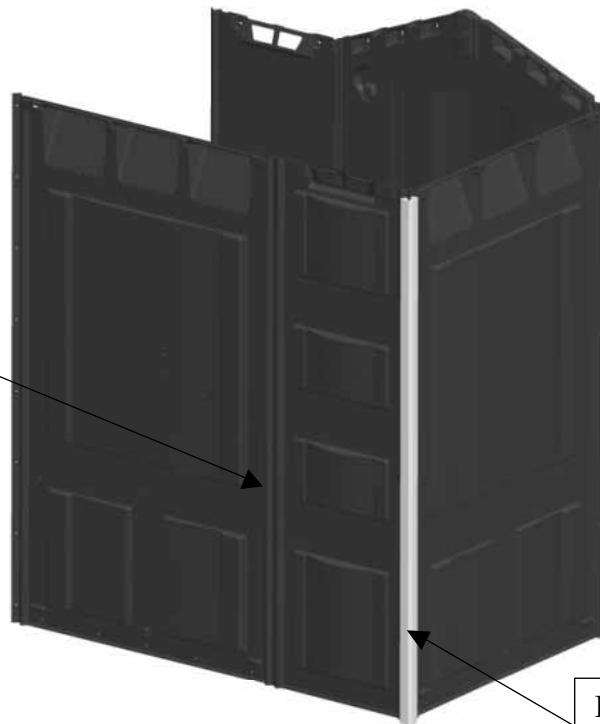

B) Connect the back panel section to the left global side panel, using the PT-HDWE-030-1 heavy-duty

**Figure 4**



**Step 5:**

- A. Assemble the right global side panel, using 2) PT-HDWE-030-1 heavy-duty extrusions. The first extrusion is to connect the right panel to the back panel. The second extrusion is to connect to the front half panel.
- B. Using a 13/64 drill, and using the pre-drilled holes in the extrusions, drill into the side panels and use the SHD-HDWE-020 rivet to attach the corner extrusions to the side panels.

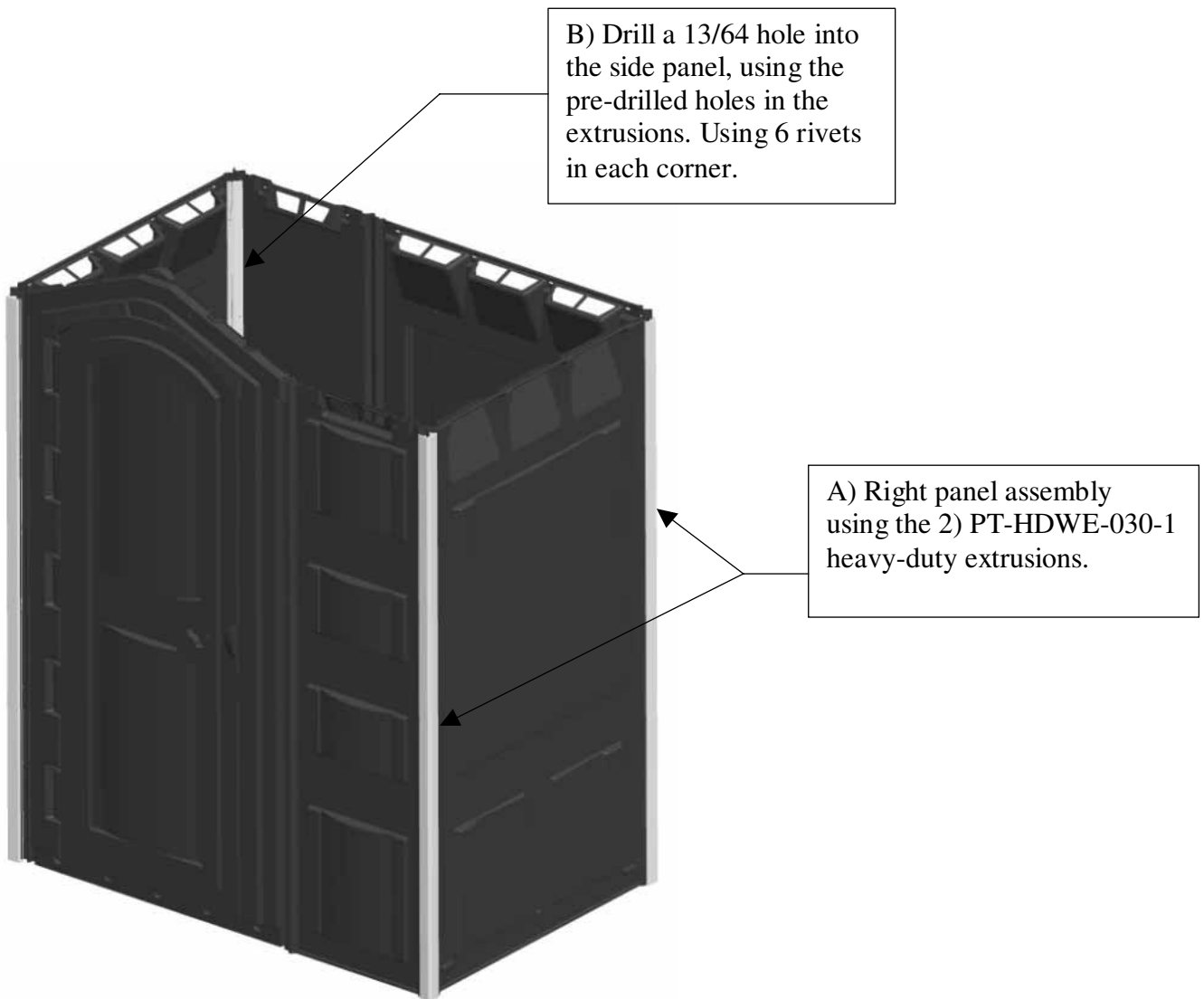
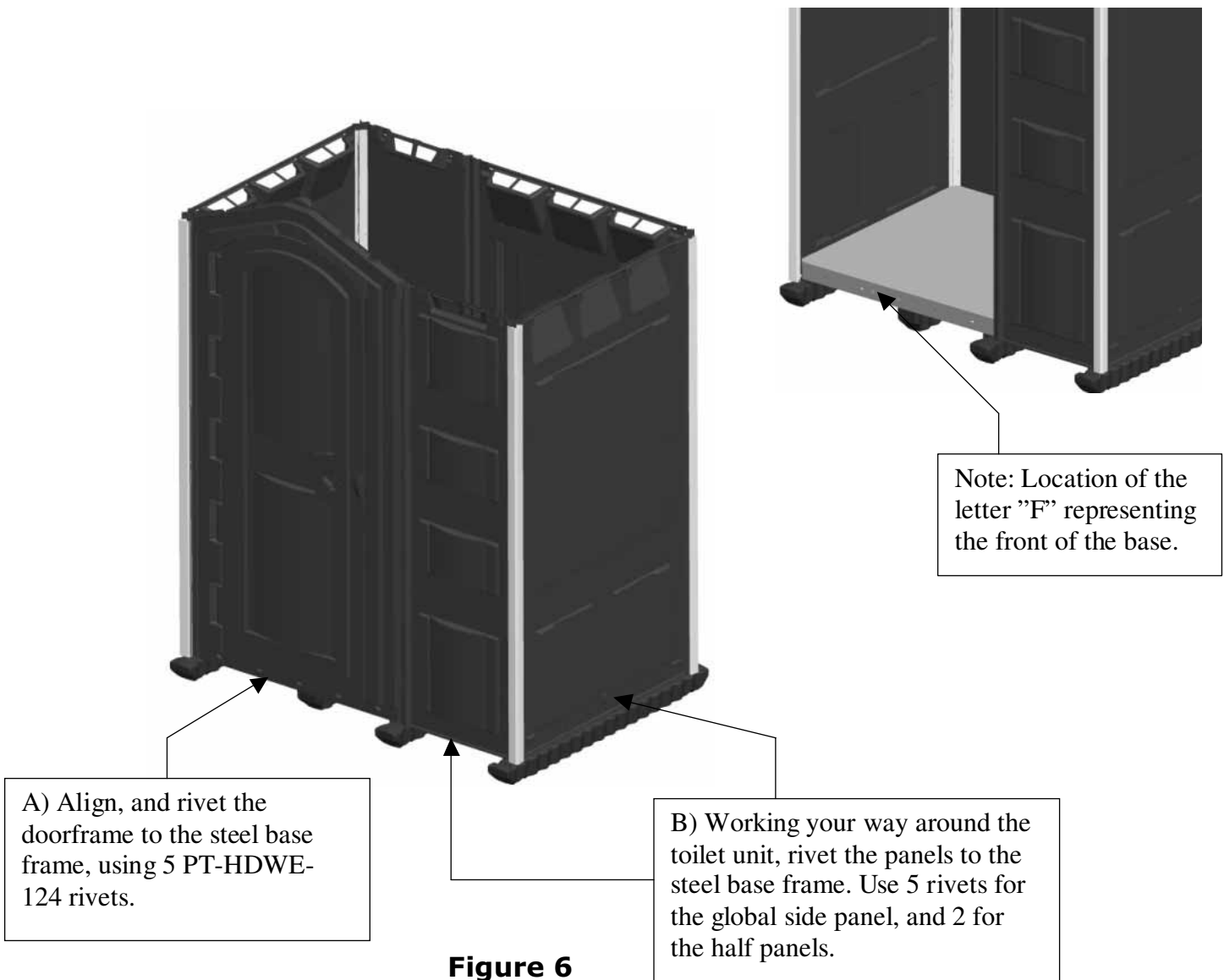

**Figure 5**



**Step 6:**

- A. Place the toilet shell on the base. **Note:** The base front is labeled with the letter "F". Align and rivet the doorframe of the toilet shell to the base first, using 5 PT-HDWE-124 rivets. Riveting the doorframe first will help locate the rest of the unit to the base.
- B. Once the frame is riveted in place, work your way around the toilet unit, riveting the panels to the base frame. **Note:** The steel base frame has pre-drilled holes. (5 rivets for each global side panel, and 2 rivets for the two half panels).





**Step 7:**

- A. Insert the tank into the unit by going through the door. Once in place, use a 13/64" drill to drill the 7) locations in the panels, and into the tank.
- B. Rivet the tank in place using 7) PT-HDWE-016 rivets.

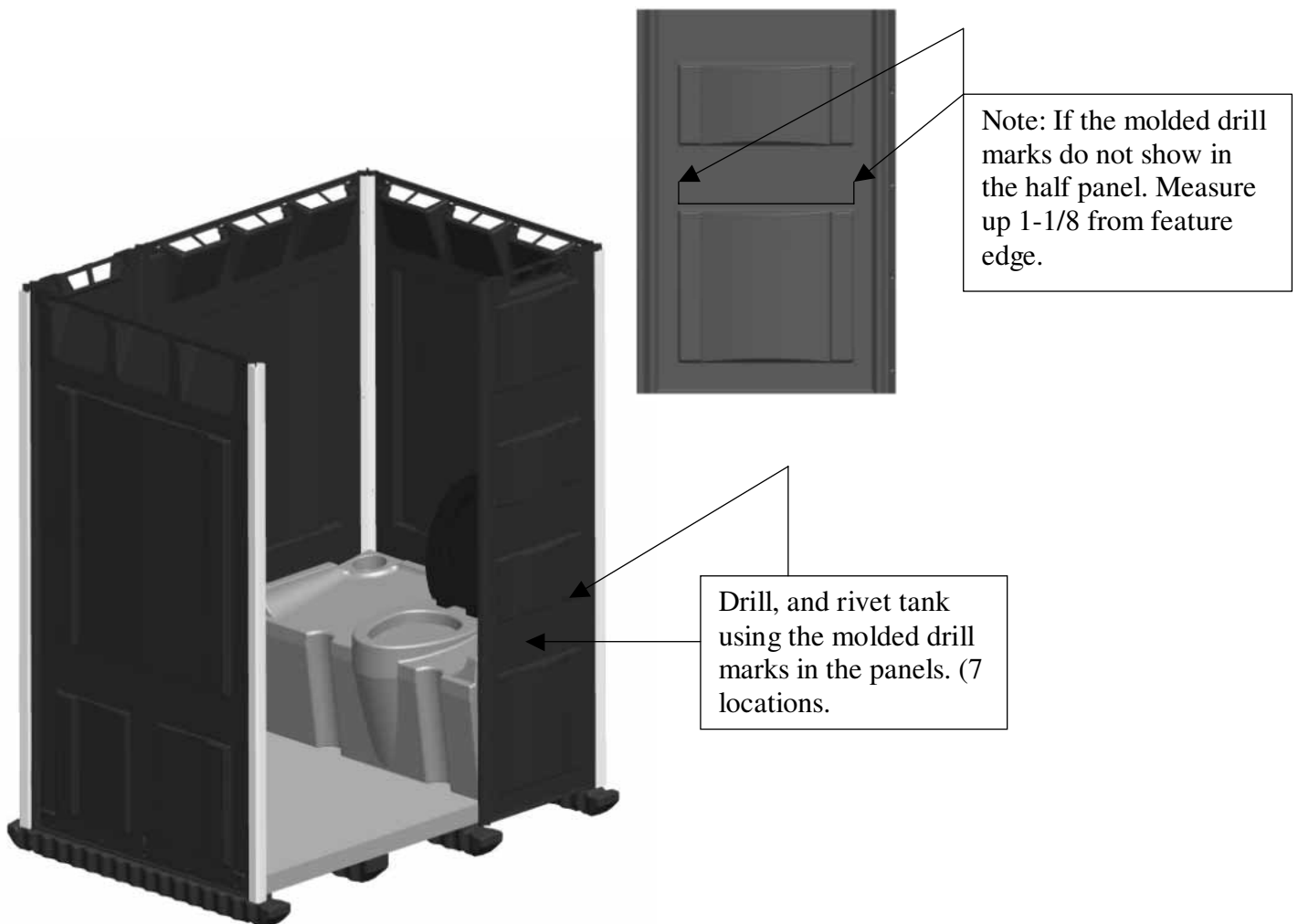

**Figure 7**



**Step 8:**

Install Door Handle. **See Fig 8**

A. Assemble Door Handle to Door using:

- a. (1) Screw, Round Head Phillips PT-HDWE-018
- b. (1) Washer, SHD-HDWE-013
- c. (1) Nut, CC-HDWE-019
- d. Washer, PT-HDWE-037

**Note:** Washer: PT-HDWE-037 is on outside of door

B. Tighten nut until threads are engaged with nylon lock nut, at least one full thread must be showing, otherwise nylon nut will loosen and fall off.

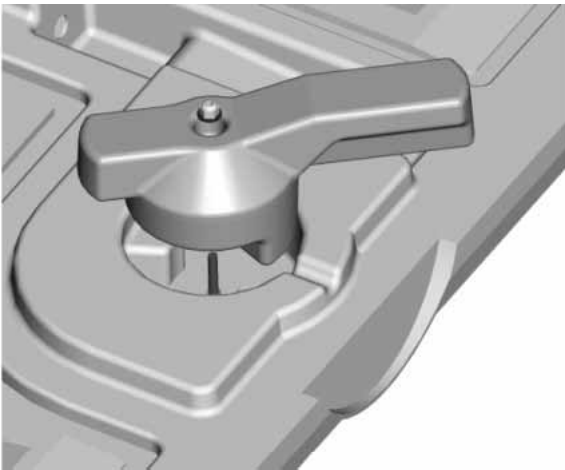

**Figure 8**



**Step 9:**

Assemble Vent Tube to unit. **See Fig 9**

A. Insert Vent Tube into Toilet Tank. **Note:** Tube should rest between side panels.

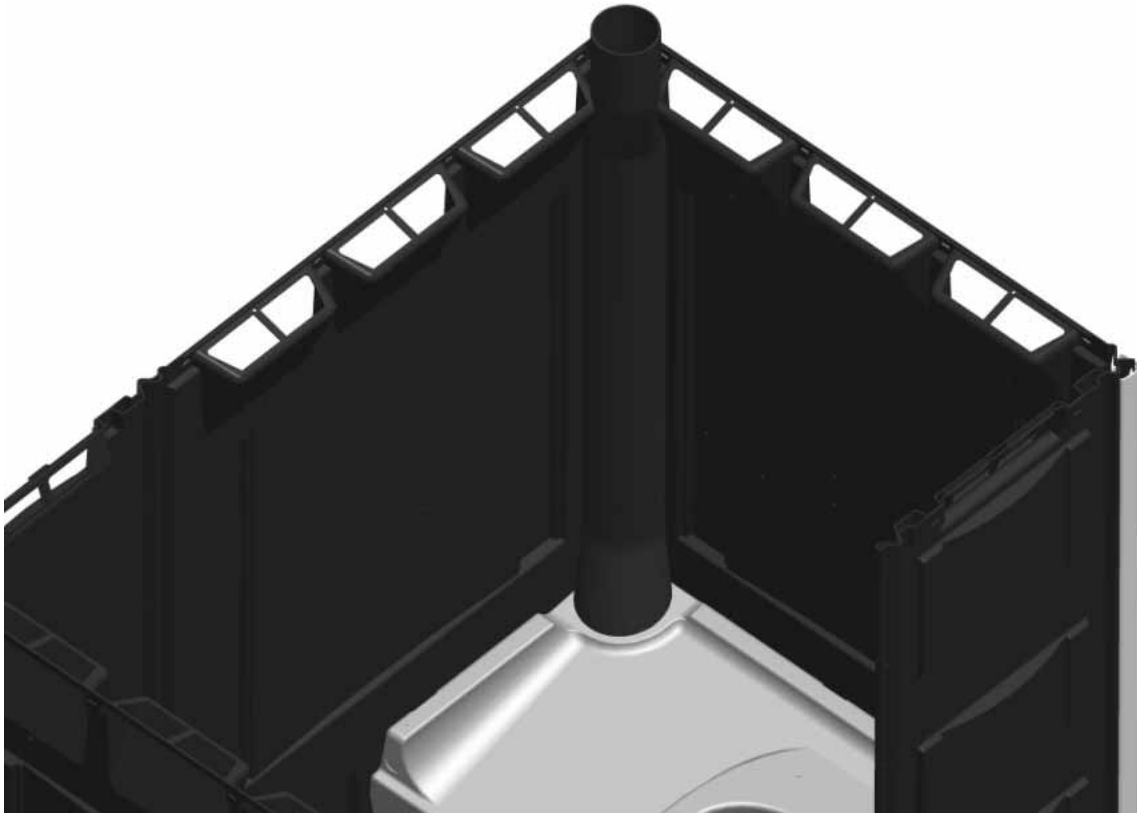

**Figure 9**



### **Step 10:**

Assemble Roof to unit.

A. Place roof on top of unit. Assemble roof to unit using:

- a. (22) Large Head Rivets SHD-HDWE-018
- b. (22) Back-up Washer: SHD-HDWE-004
- c. (2) Large head bulbex rivets: SHD-HDWE-020A **Note:** Because of the vent tube, use these two rivets without back-up washers to make it easier to assemble roof.

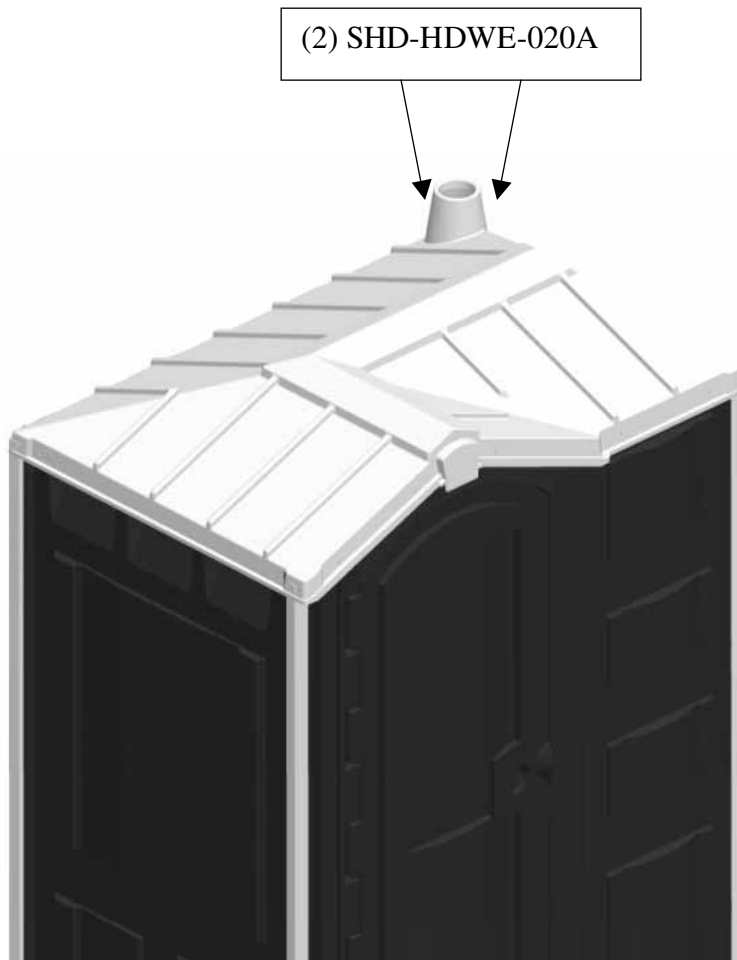

(8) Rivets on front  
(6) Rivets on back  
(4) Rivets each left,  
and right side.

Back-up washers  
Are installed on  
inside of unit.

**Figure 10**



**Step 11:**

Assemble Toilet Paper Holder to unit.

A. Using 13/64" Drill Bit, Drill (4) holes in side panel. **See Fig 11**

B. Assemble Toilet Paper Holder to unit using:

a. (4) Large Head Rivets SHD-HDWE-018

b. (4) Back-up Washer: SHD-HDWE-004

**Note:** Back-up Rivets are installed on inside of paper holder

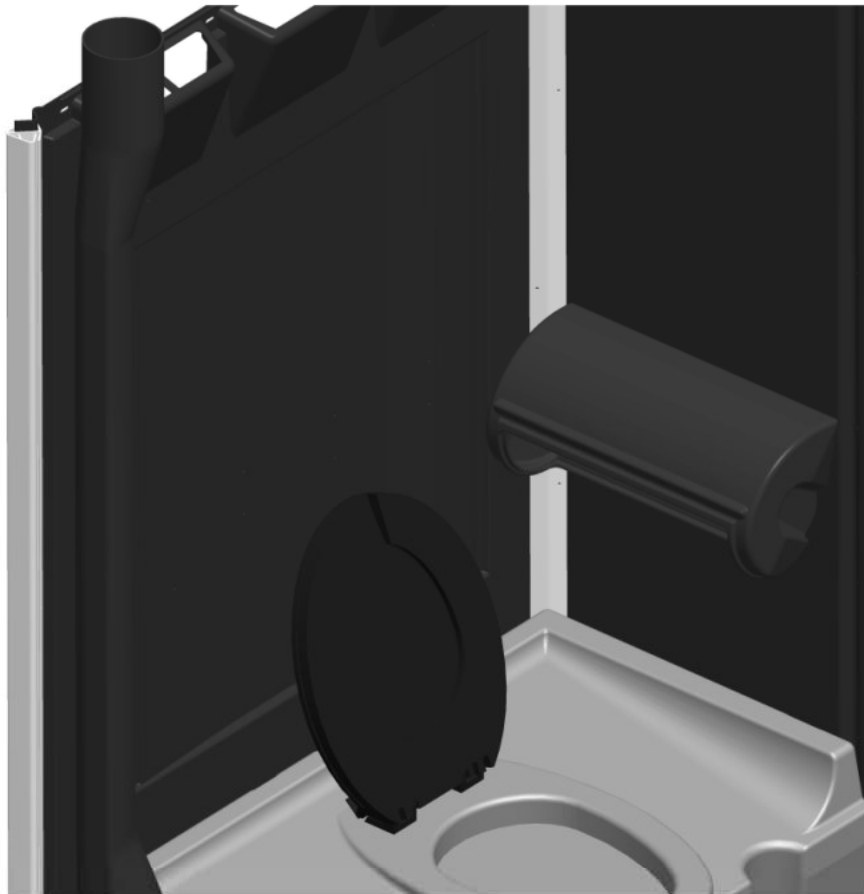

13/64" DIA drill,  
and rivet (4) Places  
at molded drill  
dimples.

**Figure 11**



## **Step 12:**

Assemble Urinal to unit.

- A. Using 13/64" Drill Bit, Drill (2) holes in side panel at molded drill points. **See Fig 12**
- B. Insert Urinal Spout in tank urinal hole.
- C. Line up holes in Urinal with holes in panel
- D. Bend Fastening tab back to meet panel, drill hole, and rivet tab to urinal. **See Fig 13**

Assemble Urinal to unit using:

- a. (3) Large Head Rivets SHD-HDWE-018
- b. (3) Back-up Washer: SHD-HDWE-004

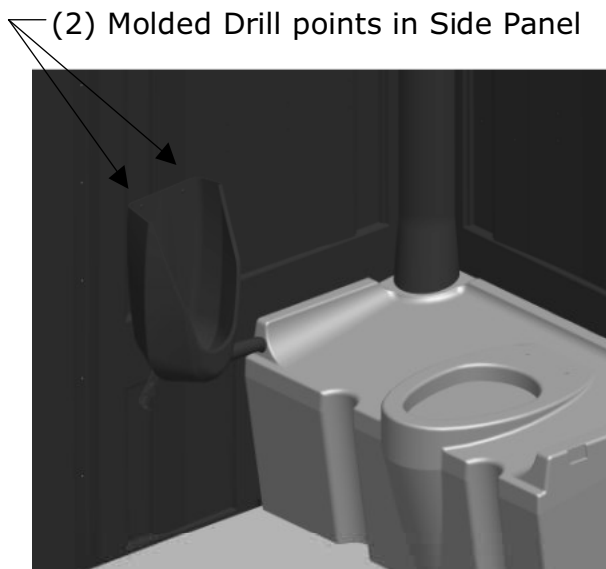

**Figure 12**



**Figure 13**



**Step 13:**

Assemble Shelf to unit

A. Using 13/64" Drill Bit, Drill (4) holes in side panel at molded drill points. **See Fig 14**

B. Assemble Shelf to unit using:

- a. (4) Large Head Rivets PT-HDWE-016

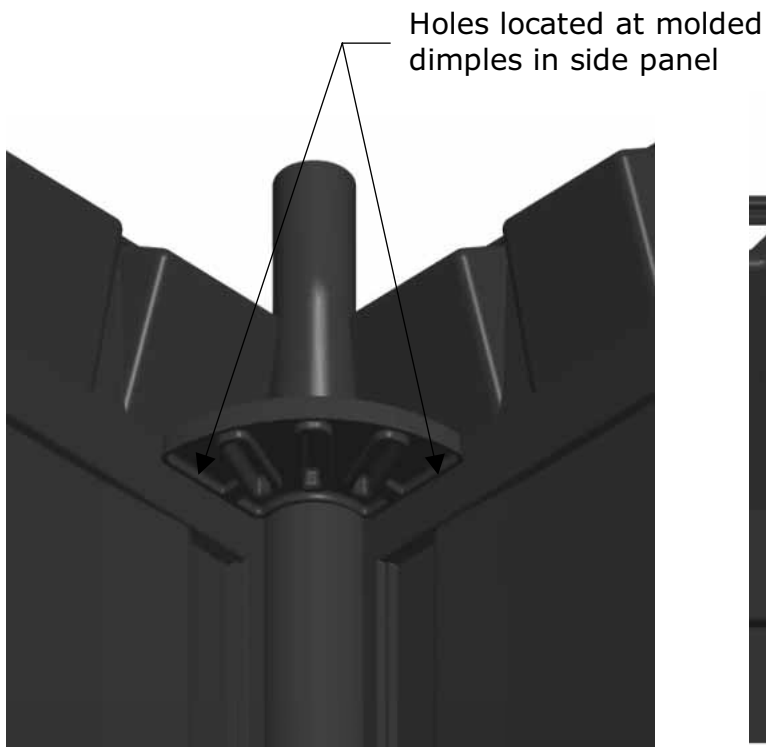

**Figure 14**

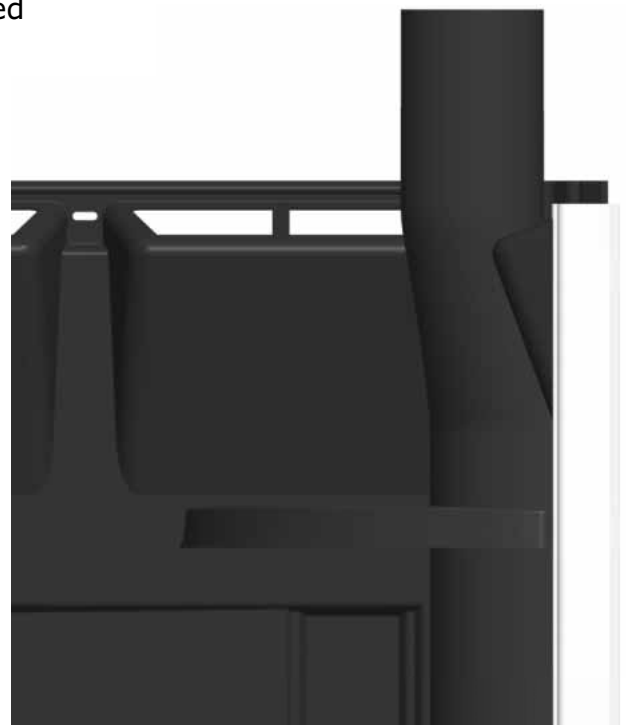

**Figure 15**



**Step 15:**

Assemble coat hook to doorframe.

- a) Assemble the PT-HDWE-217 coat hook to the door frame using a PT-HDWE-221, Rivet.  
**See Fig 16 and 17**

**Notes:**

- 1). There is a dimple location on the doorframe for the rivet location.
- 2). Pre-drilled hole is required...use 13/64" drill bit



**Figure 16**

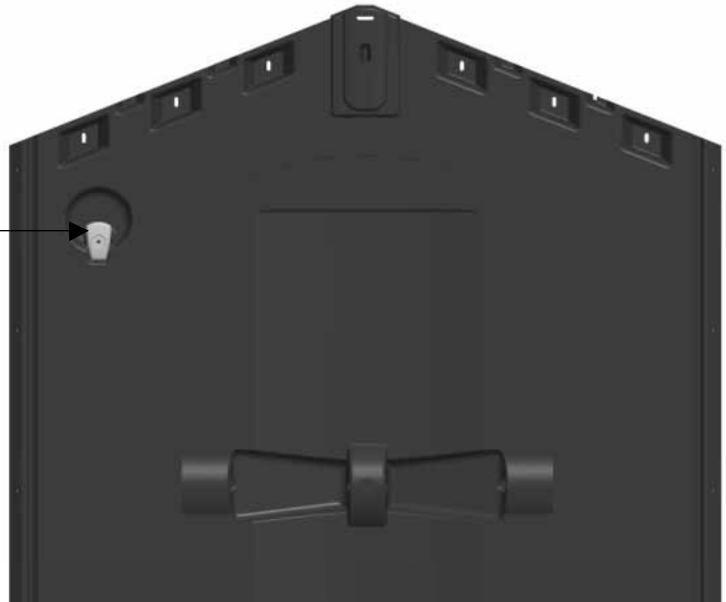

**Figure 17**