

Global II Portable Restroom

T Extrusion Molding

Assembly Instructions

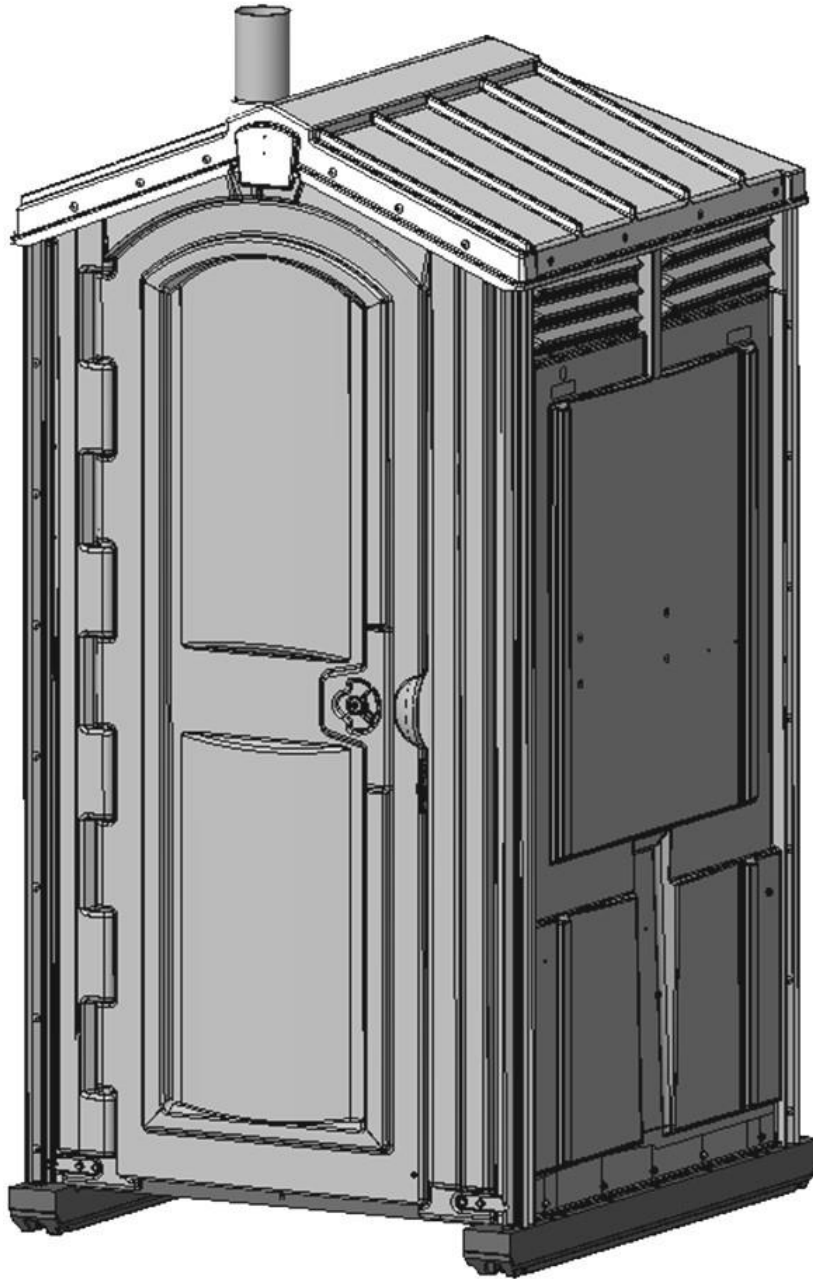

The Most Rugged Portable Restroom and Parts in the Industry!



2530 Xenium Lane North, Minneapolis, MN 55441
Telephone: 763-553-1900 Fax: 763-553-1905
800-328-3332 / www.satelliteindustries.com

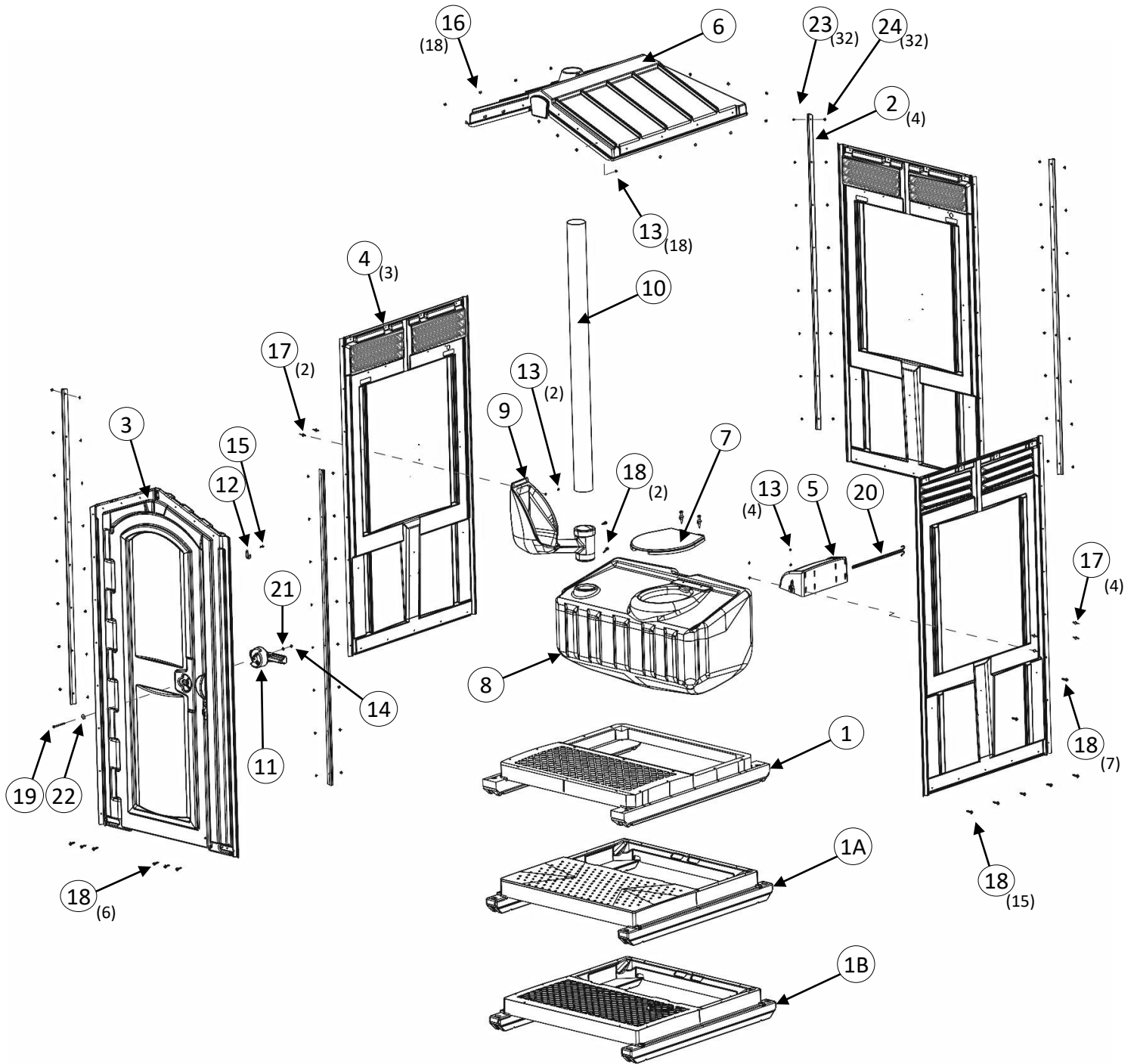

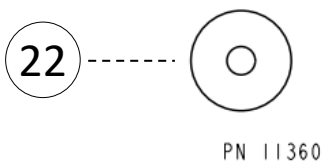
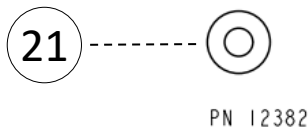
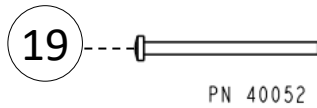
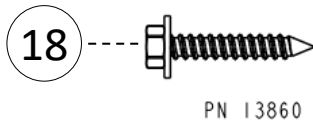
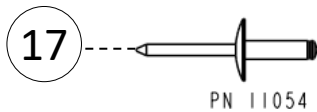
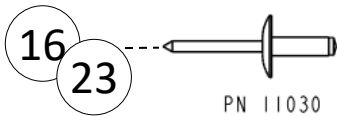
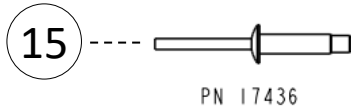
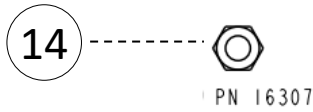
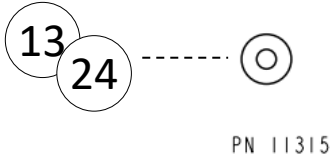
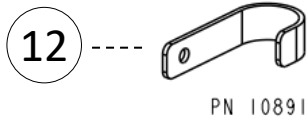
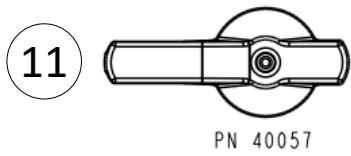

2

KIT- GB T EXT HDWE ADD ON (40083)			
24	11315	32	WASHER, 3/16 RIVET STNLS
23	11030	32	RIVET- #66 AA POP

1

HDWE GB II (40225)			
22	11360	1	WASHER- ¼ ID FENDER STNLS
21	12382	1	WASHER- ¼ FLAT STNLS
20	22310	1	SPINDLE- PRGRD II 3 ROLL METAL
19	40052	1	SCREW- 1/4 -20x3-1/2 PH PNHD SS
18	13860	30	SCREW, #14 X 1-1/2 W/WSH GOLD
17	11054	6	RIVET, #68 AAL POP
16	11030	18	RIVET. #66 AAL POP
15	17436	1	RIVET, AVDEL SILVER
14	16307	1	NUT-1/4-20 NYLOC STNLS
13	11315	24	WASHER, 3/16 RIVET STNLS
12	10891	1	HOOK, FLAT COAT STNLS
11	40057	1	HANDLE- GB TOILET

GLOBAL II RESTROOM

10	14133	1	VENT PIPE. 4 X 62-1/2 GREY
9	14119	1	URINAL, STAND OVER DGRY
8	10553	1	TANK, TUFWAY DGRY
7	10570	1	SEAT, TOILET TUF/FRE/LIB BLACK
6	40223	1	ROOF- GB II NATURAL
5	22209	1	HOOD- PAPERGRD 3 ROLL DGRY
4	40224	3	DESIGN, GB II PANEL
	40083	1	KIT- GB T EXT HDWE ADD ON
	40225	1	HDWE GB II
3	22202	1	DESIGN, GB II FRONT ASSY
2	40020	4	EXTRUSION- GB T DRILLED BLACK
1B	10033		BASE ASSY- IMPACT GRID FLOOR
1A	10034	1	BASE ASSY- IMPACT SOLID FLOOR
1	40014	1	BASE- GB DIRT BUSTER
ITEM	PART#	QTY	DESCRIPTION

Tools Needed:

- | | | |
|-------------------------|---------------------|-------------------|
| 1. Drill / Driver | 2. #10 Drill Bit | 3. Rivet Gun |
| 4. Phillips Screwdriver | 5. 7/16" Nut Driver | 6. 1/4" Drill Bit |

Step 1: Assemble (3) side panels using "T" extrusion:

1. Slide T Extrusion between (2) panels.
2. Align holes in the panels with T Extrusion.
3. Fasten with (8) rivets #11030 and (8) washers #11315. Washers should face rear panel & rivets face front of unit, repeat on other side.

Tip: It may help to elevate Rear panel on assembly table or a stack of tanks while assembling side panels to rear panel.

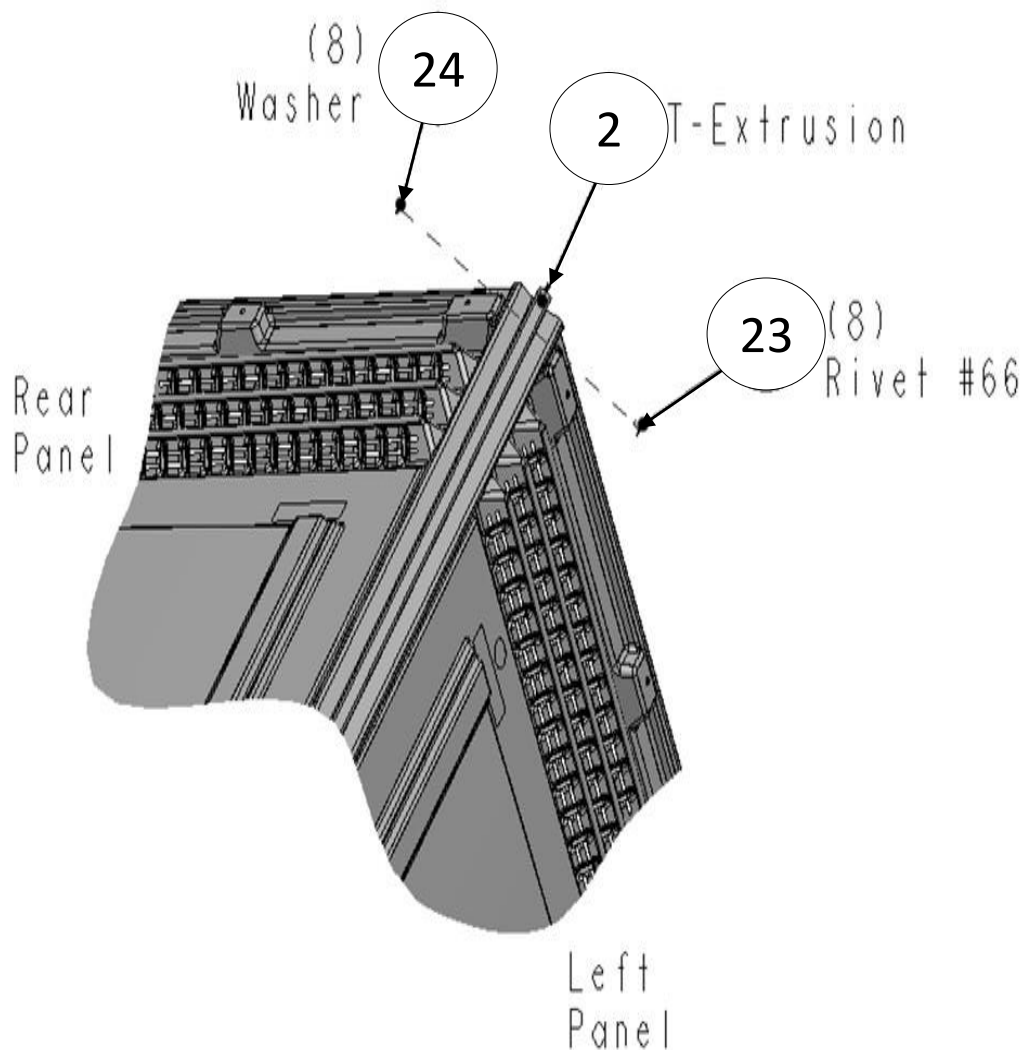

Step 2: Assemble Impact Base to side panels:

1. Place bottom edge of the side panels against the spacer ribs in corners of base. Align panel center hole with center bump on base and fasten with Screw #13860. Install remaining (4) screws.
2. Repeat process for other side panel.
3. Align rear panel's center hole with center bump on base and align its bottom edge with the bottom edges of the side panels, then fasten with Screws #13860.

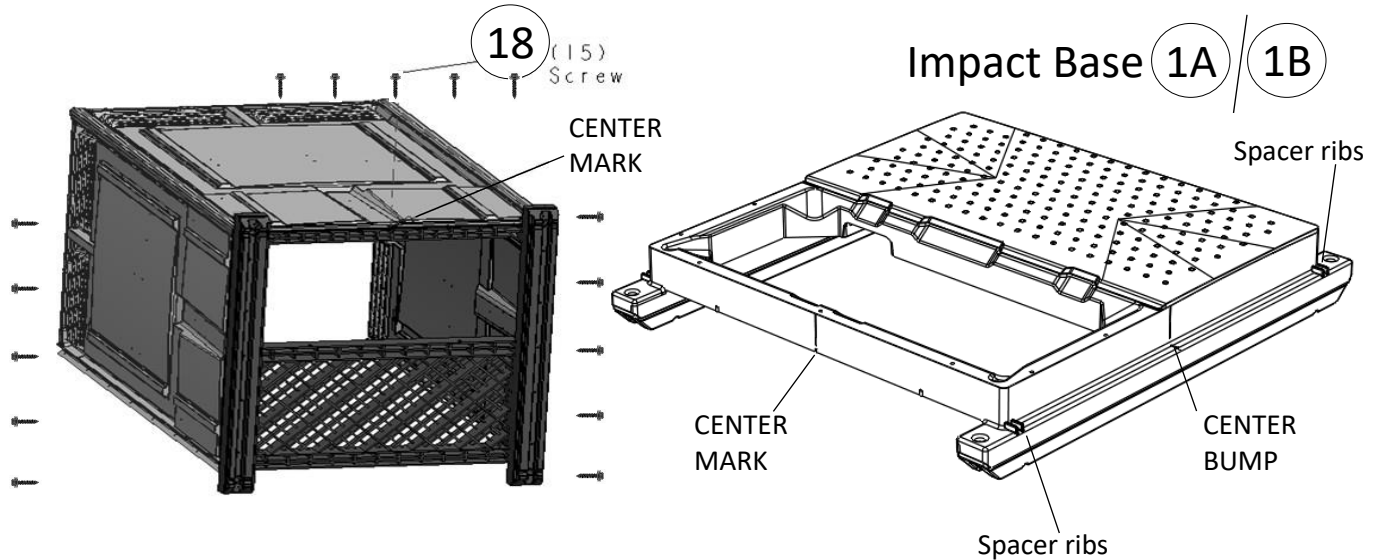

Or Step 2: Assemble Dirt Buster Base to side panels:

1. Butt bottom of the rear panel up against the runners. Align rear panel center hole with center mark on base and fasten with Screw #13860. Finish remaining (4) holes.
2. Align side panel's center holes with grooves on base sides down to top of base runner and fasten with Screws #13860.

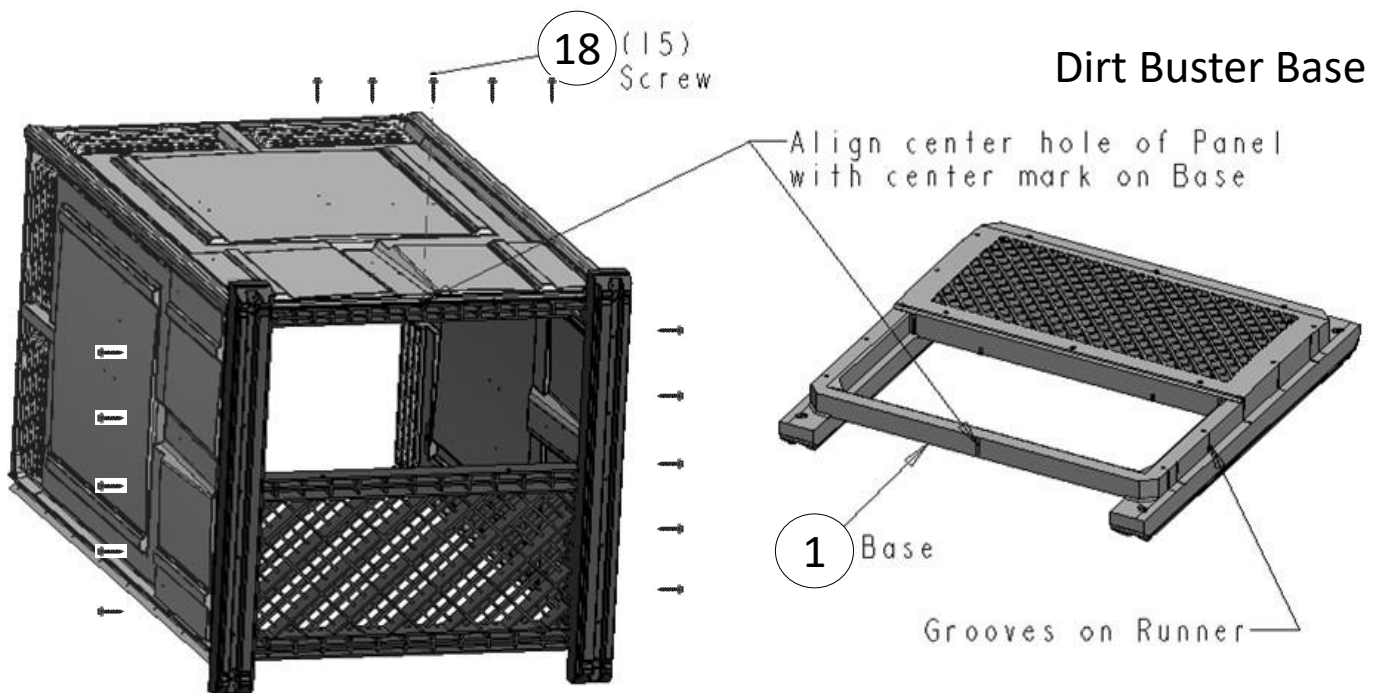

Step 3: Fasten Tank in Unit:

- Place tank against the back wall and hold tank down into position. Attach the tank the sides, while (1) person holds tank down. This ensures that the tank is positioned correctly. Tighten screws #13860 until rubber washer begins to flatten.
WARNING: DO NOT TO OVER TIGHTEN SCREWS.
- See location chart on below for screw locations.
Note: Use only the dimples that match chart locations.
- Fasten toilet seat.

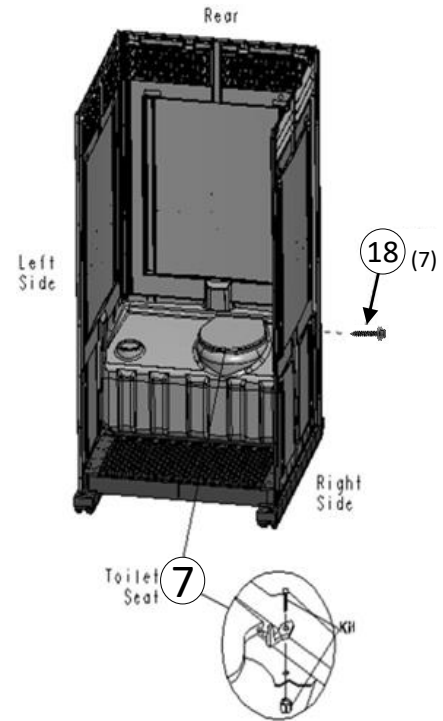

Outside view dimple location

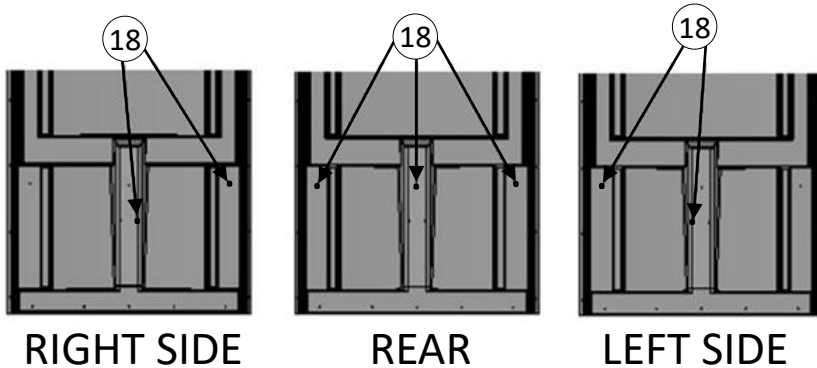

Step 4: Assemble Paperguard to unit:

- Using #10 Drill Bit, Drill out the (4) dimples on side panel as shown.
- Fasten Paper Guard to unit using (4) Rivets #11054 and (4) washers #11315.
(Washers are installed on inside of paper guard.)
- Insert spindle 22310 in Paper Guard.

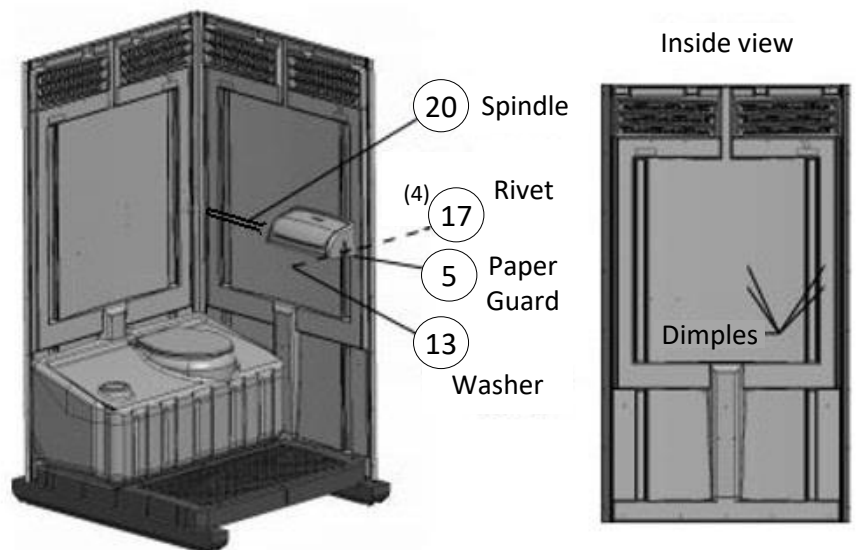

Step 5: Assemble Urinal to unit:

1. Using #10 Drill Bit, Drill (2) holes in side panel at dimples. *If dimples are not present on panel, transfer drill these two holes after urinal is inserted in tank.*
2. Insert round tube of Urinal in tank urinal hole.
3. Use (2) rivets #11054 and (2) washers #11315. *Washers are installed on inside of Urinal.*
4. Fasten urinal to tank using 1 screw #13860 in dimple located on back of tank collar.

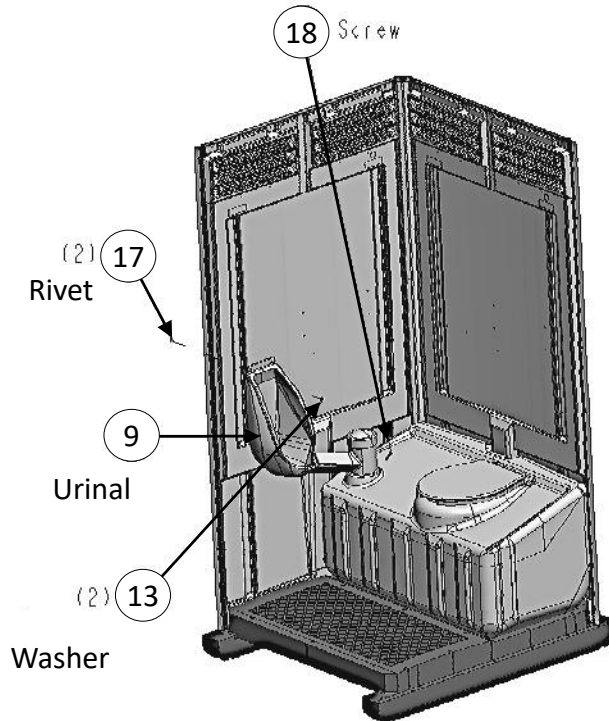

Inside View

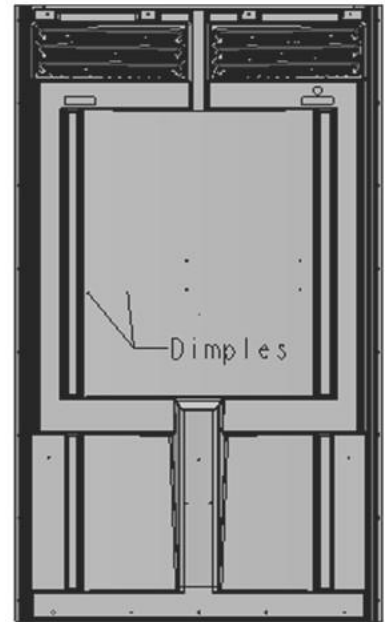

Step 6: Assemble coat hook to doorframe.

1. Drill at dimple using #10 drill bit
2. Fasten Coat Hook to the frame using Rivet #17436.

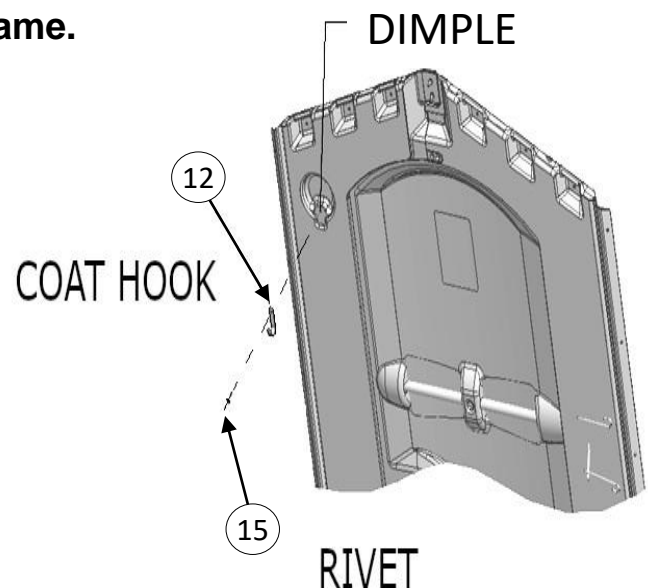

Step 7: Install Door Handle.

1. Install Door Handle on Door using (1) Screw #40052, (1) Washer Fender #11360, on outside of door and (1) Handle #40057, (1) Washer Flat #12382 and (1) Nut #16307 on door inside.
2. Tighten nut using 7/16" Deep Well Socket & Phillips screwdriver until threads are engaged with nylon in lock nut, at least one full thread must be showing.

Note: nyloc nut will loosen and fall off if not properly tightened.

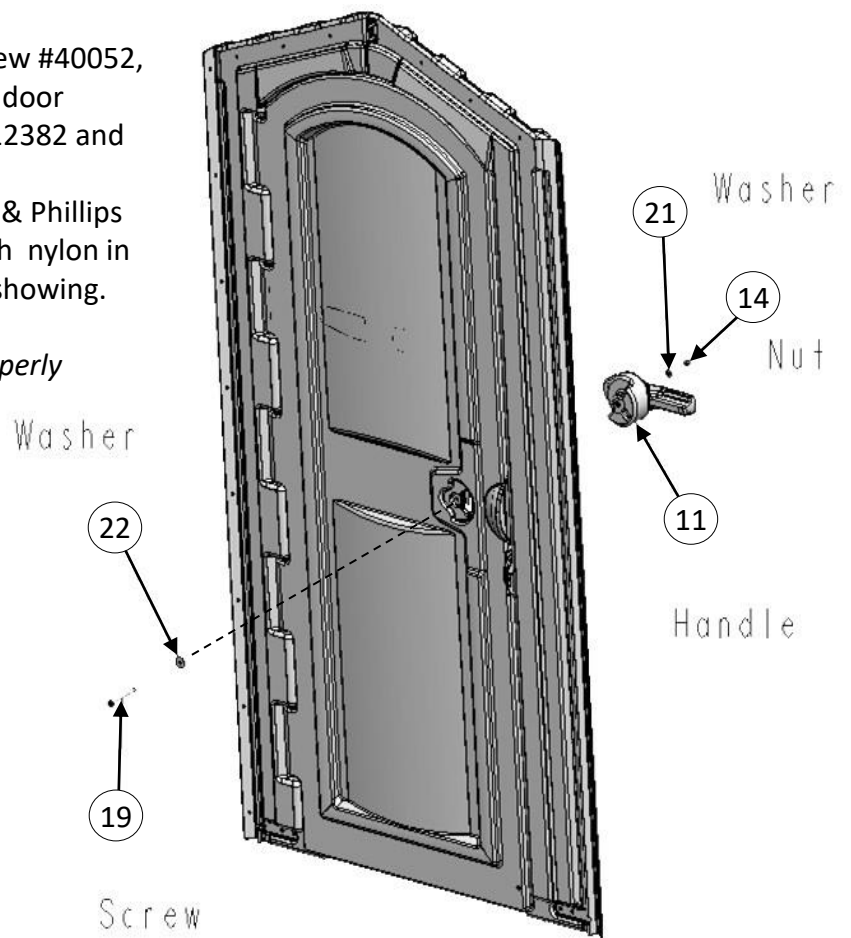

Step 8: Assemble Front to panels.

1. Install T Extrusions between the front and panels. Fasten front to panels with (16) Rivets #11030 and (16) washers #11315. Make sure that the rivets heads are on front side and washers are on the panel side.

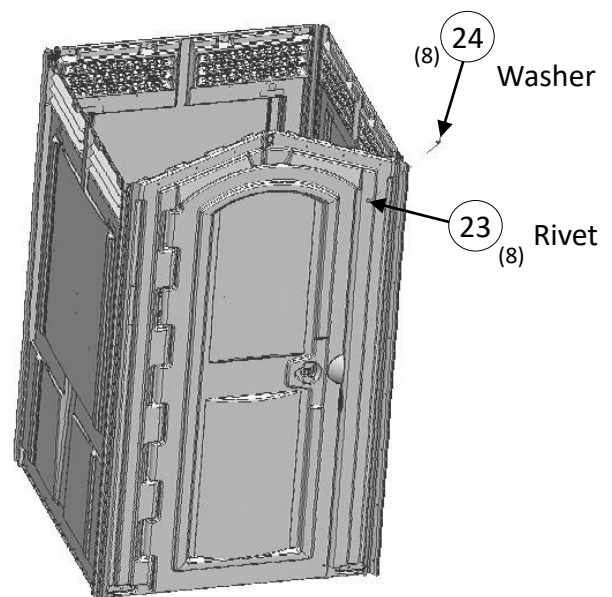

Step 9: Assemble Front to Base.

1. Install (2) screws through pre-drilled holes in bottom of door frame left side & (2) screws through pre-drilled holes in bottom of door frame right side.
2. Remove shipping screw, open the door and install final (2) screws #13860 through two pre-drilled holes behind the door, near inside edge of frame, (1) left and (1) right side.

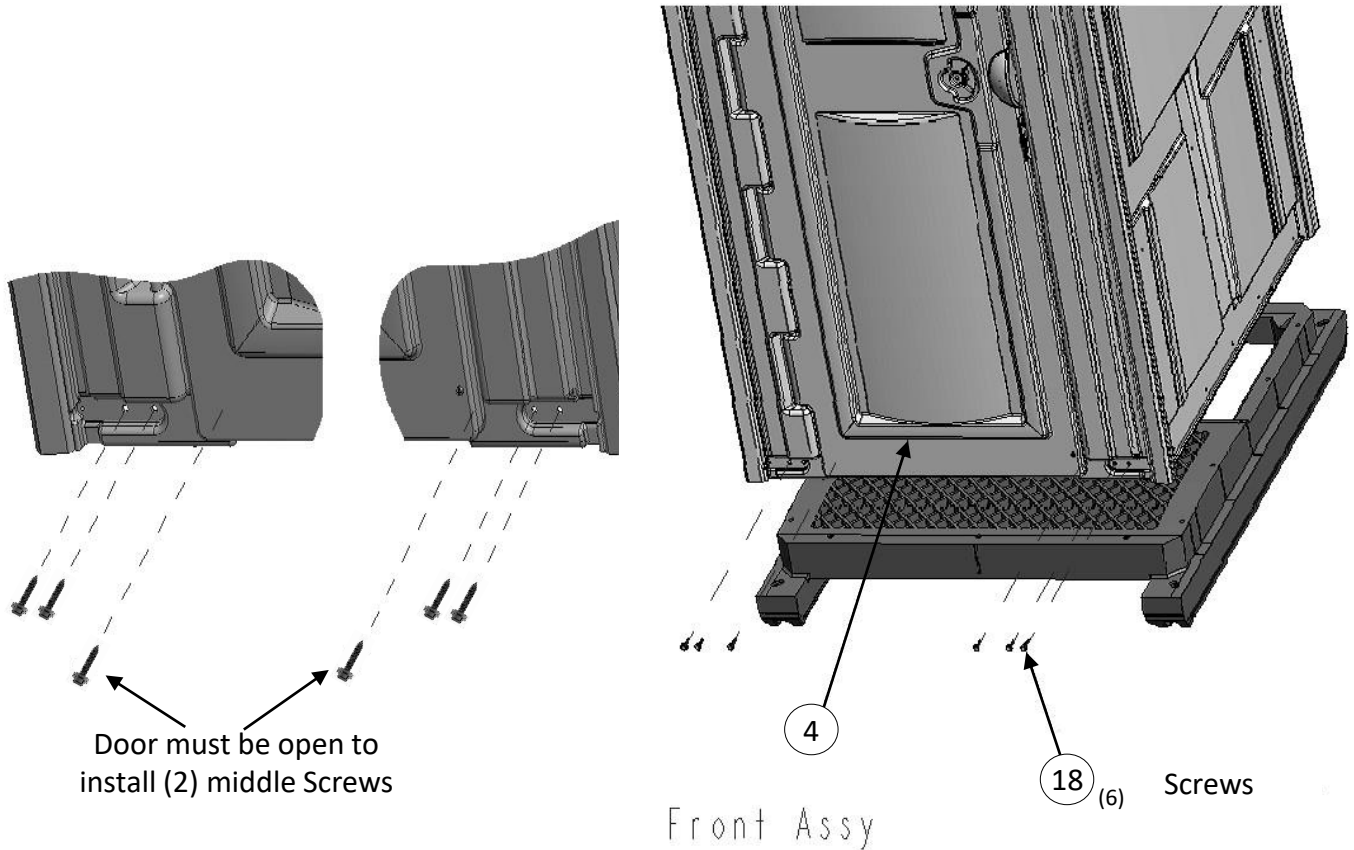

Step 10: Assemble Roof to unit.

1. Place roof on top of unit. Fasten roof to unit use (18) Rivets #11030 & (18) Washers #11315
Washers are installed on inside of unit.

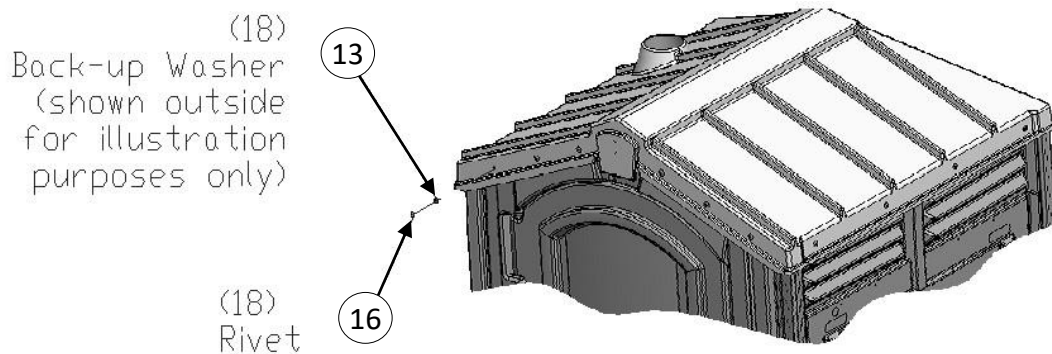

Step 11: Assemble Vent Pipe to unit.

1. Push Vent Tube up through roof then down into top of urinal tube.
2. Fasten vent pipe to urinal tube using (1) screw #13860 through dimple located on back of urinal tube.

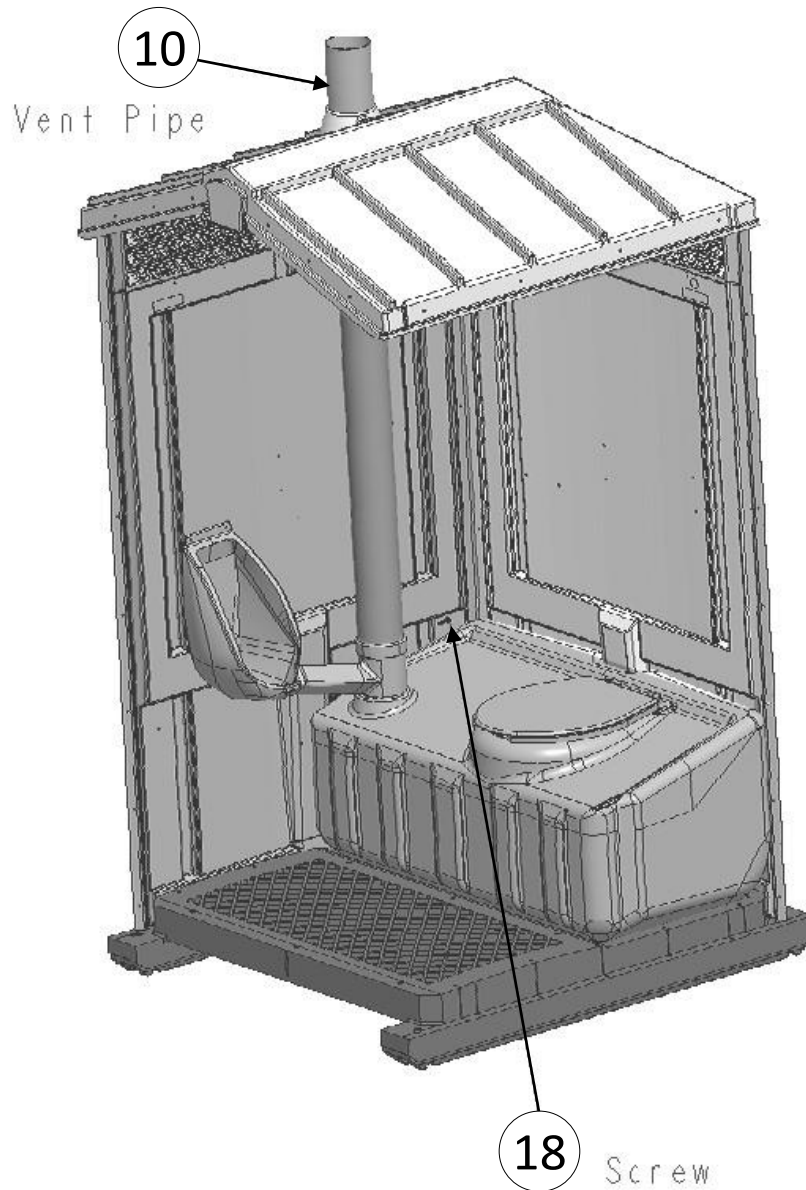

2530 Xenium Lane North, Minneapolis, MN 55441
Telephone: 763-553-1900 Fax: 763-553-1905
800-328-3332 / www.satelliteindustries.com