



# el•e•gant

1. pleasingly graceful and stylish in appearance or manner.



## 14' 3-D SUITE

Most three-station trailers are 12', but this trailer is two feet longer and the advantage is clearly felt and seen when using the separate stations. The other benefit, which is also true with all other Satellite Suites trailers, is the position of all doorways on the same side of the trailer.





# TRAILER SUITES

- FLOOR PLANS
- POPULAR SUITES PRODUCTS
- URINAL VALVE ASSEMBLY
- FAUCET ASSEMBLY
- AQUA MAGIC SEAT ASSEMBLY
- ADDITIONAL PARTS & HARDWARE

- SCAN THE QR CODE FOR OWNERS MANUALS, ADDITIONAL SPECS, & MORE SUITES INFO!



# RESTROOM TRAILER FLOOR PLANS

## SELFIE MODELS

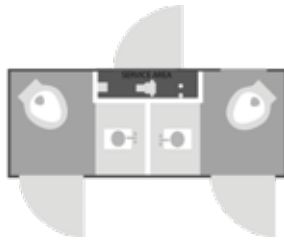

**SELFIE POD**

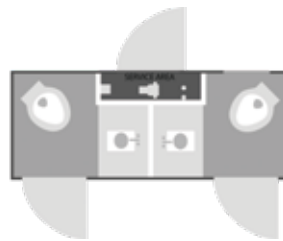

**SELFIE SLIM**

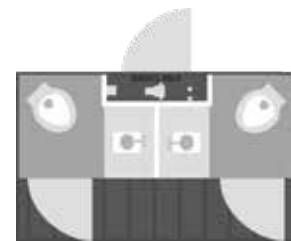

**SELFIE**

**NO. OF STATIONS**  
**LENGTH/W TONGUE**  
**WIDTH/W STEPS**  
**HEIGHT/W AC**  
**FRESH TANK**  
**WASTE TANK**  
**WEIGHT**  
**AXLE TORSION**

2  
 9'1"  
 3'6" | 4'7"  
 8'2" | 9'3"  
 94 GAL.  
 132 GAL.  
 2,820 LBS.  
 NA

2  
 9'1" | 13'6"  
 5'2" | 6'6"  
 8'10" | 9'11"  
 103 GAL.  
 132 GAL.  
 3,300 LBS.  
 3,500 LB.

2  
 10'6" | 15'2"  
 7'7" | 8'8"  
 9'2" | 10'2"  
 104 GAL.  
 205 GAL.  
 3,800 LBS.  
 (2) 3,500 LB.

## RESTROOM MODELS

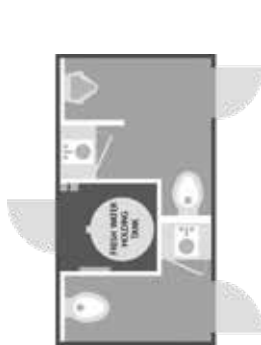

**10 FOOT**

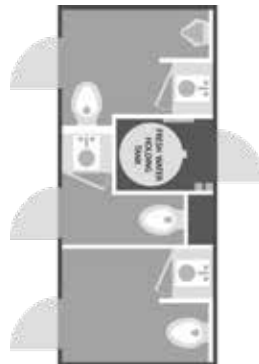

**14 FOOT | 3 DOOR**

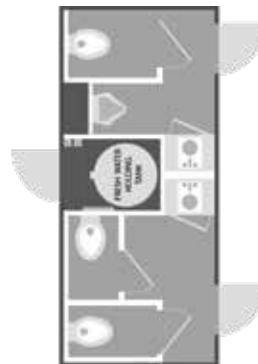

**14 FOOT | 2 DOOR**

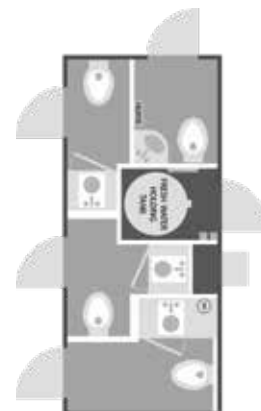

**14 FOOT | 4 DOOR**

**NO. OF STATIONS**  
**LENGTH/W TONGUE**  
**WIDTH/W STEPS**  
**HEIGHT/W AC**  
**FRESH TANK**  
**WASTE TANK**  
**WEIGHT**  
**AXLE TORSION**

2  
 10' | 15'  
 6' | 7'6"  
 10'11"  
 105 GAL.  
 265 GAL.  
 4,200 LBS.  
 7,000 LB.

3  
 14'4" | 19'  
 6'5" | 9'2"  
 11'3"  
 200 GAL.  
 390 GAL.  
 5,280 LBS.  
 7,000 LB.

4  
 14'4" | 19'  
 6'5" | 9'2"  
 11'3"  
 200 GAL.  
 390 GAL.  
 5,280 LBS.  
 7,000 LB.

4  
 14'4" | 19'  
 6'5" | 9'2"  
 11'3"  
 200 GAL.  
 390 GAL.  
 5,280 LBS.  
 7,000 LB.

# RESTROOM MODELS CONTINUED

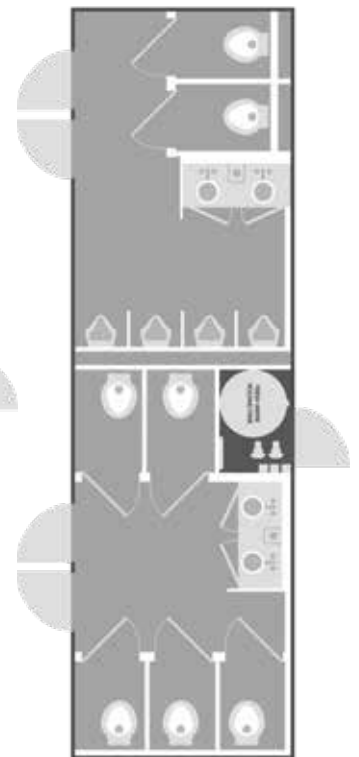
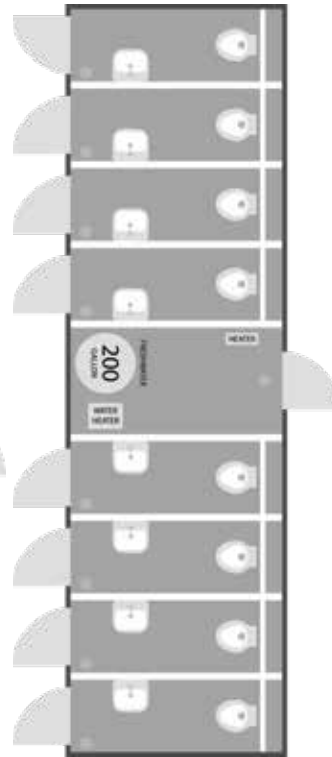
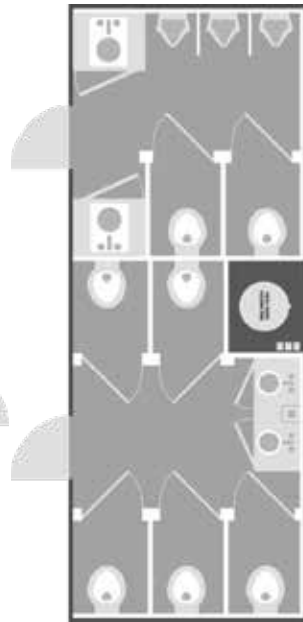
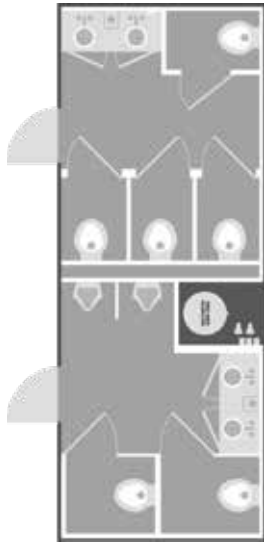

	20 FOOT	25 FOOT	28 FOOT   8 DOOR	28 FOOT
<b>NO. OF STATIONS</b>	8	10	8	11
<b>LENGTH/W TONGUE</b>	20'   25'	25'   30'	28'   33'	28'   33'
<b>WIDTH/W STEPS</b>	8'6"   12'6"	8'6"   12'6"	8'6"   12'6"	8'6"   12'6"
<b>HEIGHT/W AC</b>	11'8"	11'8"	11'8"	11'8"
<b>FRESH TANK</b>	200 GAL.	200 GAL.	200 GAL.	200 GAL.
<b>WASTE TANK</b>	750 GAL.	880 GAL.	1,150 GAL.	1,000 GAL.
<b>WEIGHT</b>	8,490 LBS.	9,800 LBS.	11,450 LBS.	11,450 LBS.
<b>AXLE TORSION</b>	(2) 7,000 LB.	(2) 7,000 LB.	(2) 7,000 LB.	(2) 7,000 LB.

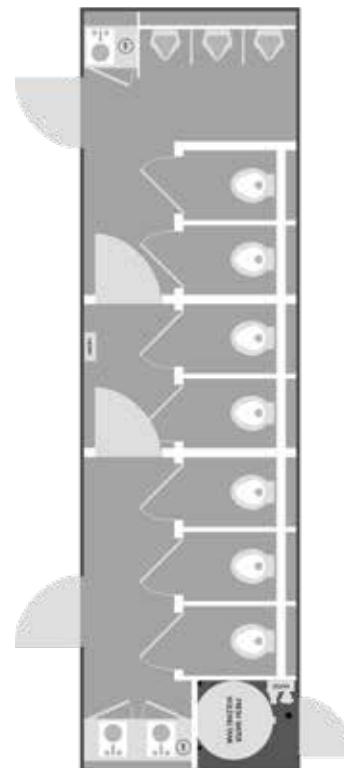
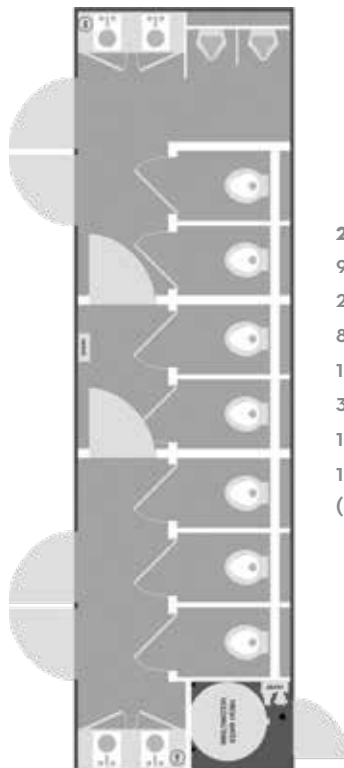

	29 FOOT   9 STATION	29 FOOT   10 STATION
<b>NO. OF STATIONS</b>	9	10
<b>LENGTH/W TONGUE</b>	29'   34"	29'   34"
<b>WIDTH/W STEPS</b>	8'6"   12'6"	8'6"   12'6"
<b>HEIGHT/W AC</b>	11'8"	11'8"
<b>FRESH TANK</b>	300 GAL.	300 GAL.
<b>WASTE TANK</b>	1,025 GAL.	1,025 GAL.
<b>WEIGHT</b>	11,980 LBS.	11,980 LBS.
<b>AXLE TORSION</b>	(2) 7,000 LB.	(2) 7,000 LB.

## ADA MODELS

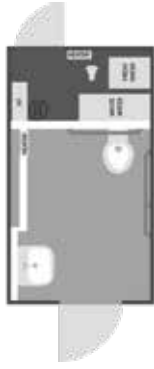

**11 FOOT**

<b>NO. OF STATIONS</b>	1
<b>LENGTH/W TONGUE</b>	11'   16'
<b>WIDTH/W STEPS</b>	6'   10'4"
<b>HEIGHT/W AC</b>	10'4"
<b>FRESH TANK</b>	63 GAL.
<b>WASTE TANK</b>	123 GAL.
<b>WEIGHT</b>	3,200 LBS.
<b>AXLE TORSION</b>	5,200 LB.

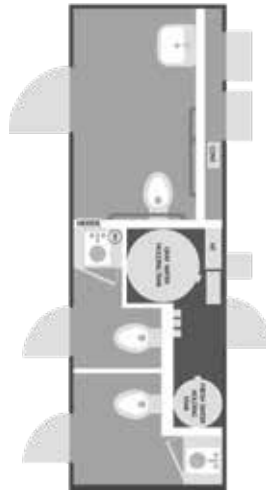

**19 FOOT**

<b>NO. OF STATIONS</b>	3
<b>LENGTH/W TONGUE</b>	19'   24'
<b>WIDTH/W STEPS</b>	6'   19'
<b>HEIGHT/W AC</b>	10'10"
<b>FRESH TANK</b>	105 GAL.
<b>WASTE TANK</b>	300 GAL.
<b>WEIGHT</b>	7,880 LBS.
<b>AXLE TORSION</b>	9,990 LB.

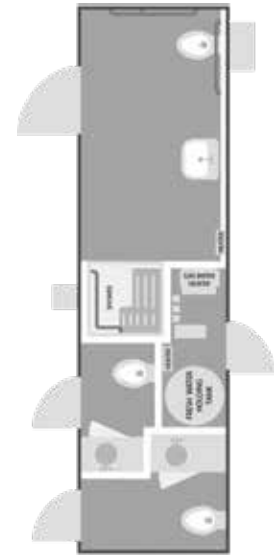

**23 FOOT**

<b>NO. OF STATIONS</b>	3
<b>LENGTH/W TONGUE</b>	23'   28'
<b>WIDTH/W STEPS</b>	6'   19'
<b>HEIGHT/W AC</b>	10'10"
<b>FRESH TANK</b>	105 GAL.
<b>WASTE TANK</b>	300 GAL.
<b>WEIGHT</b>	10,560 LBS.
<b>AXLE TORSION</b>	14,000 LB.

## HANDWASH MODELS

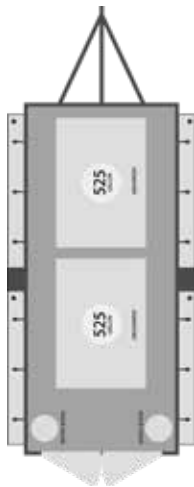

**SINK SUITE**

<b>NO. OF STATIONS</b>	12
<b>LENGTH/W TONGUE</b>	16'   21'
<b>WIDTH/W STEPS</b>	6'
<b>HEIGHT/W AC</b>	10'
<b>FRESH TANK</b>	525 GAL.
<b>WASTE TANK</b>	525 GAL.
<b>WEIGHT</b>	4,000 LBS.
<b>AXLE TORSION</b>	(2) 5,200 LB.

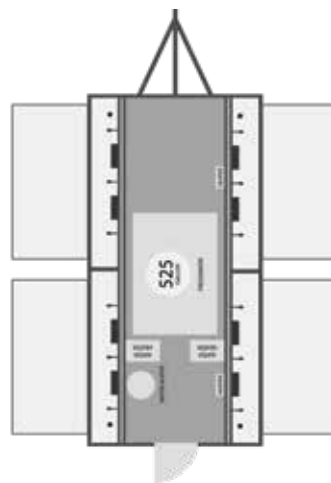

**PLUS**

<b>NO. OF STATIONS</b>	12
<b>LENGTH/W TONGUE</b>	16'   21'
<b>WIDTH/W STEPS</b>	6'
<b>HEIGHT/W AC</b>	10'
<b>FRESH TANK</b>	525 GAL.
<b>WASTE TANK</b>	525 GAL.
<b>WEIGHT</b>	4,000 LBS.
<b>AXLE TORSION</b>	(2) 5,200 LB.

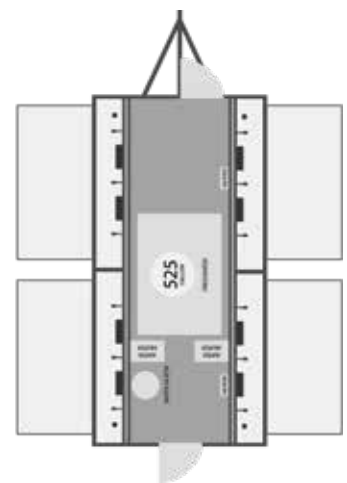

**DELUXE**

<b>NO. OF STATIONS</b>	12
<b>LENGTH/W TONGUE</b>	16'   21'
<b>WIDTH/W STEPS</b>	6'
<b>HEIGHT/W AC</b>	10'
<b>FRESH TANK</b>	525 GAL.
<b>WASTE TANK</b>	525 GAL.
<b>WEIGHT</b>	4,000 LBS.
<b>AXLE TORSION</b>	(2) 5,200 LB.

## SHOWER MODELS

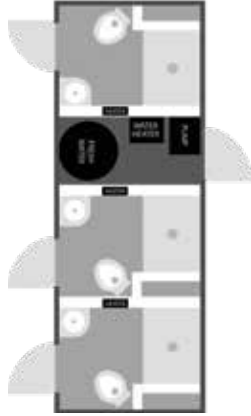

**18 FOOT | COMBO**

<b>NO. OF STATIONS</b>	3
<b>LENGTH/W TONGUE</b>	18'   23'
<b>WIDTH/W STEPS</b>	6'   7'6"
<b>HEIGHT/W AC</b>	11'6"
<b>FRESH TANK</b>	200 GAL.
<b>WASTE TANK</b>	650 GAL.
<b>WEIGHT</b>	6,000 LBS.
<b>AXLE TORSION</b>	7,000 LB.

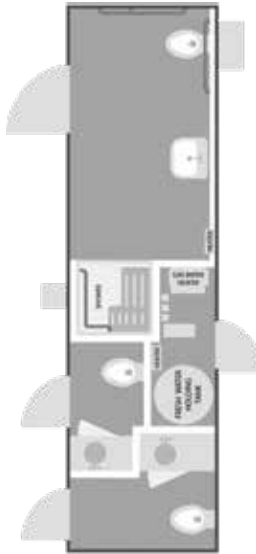

**23 FOOT | ADA**

<b>NO. OF STATIONS</b>	3
<b>LENGTH/W TONGUE</b>	23'   28'
<b>WIDTH/W STEPS</b>	6'   19'
<b>HEIGHT/W AC</b>	10'10"
<b>FRESH TANK</b>	105 GAL.
<b>WASTE TANK</b>	300 GAL.
<b>WEIGHT</b>	10,560 LBS.
<b>AXLE TORSION</b>	14,000 LB.

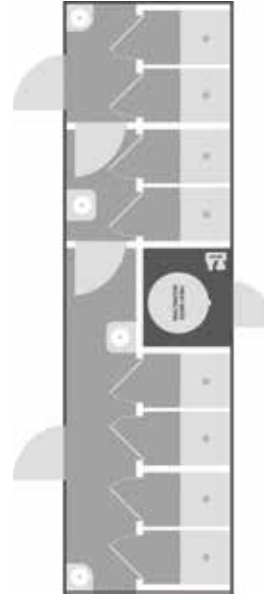

**28 FOOT | FLEX**

<b>NO. OF STATIONS</b>	8
<b>LENGTH/W TONGUE</b>	28'   33'
<b>WIDTH/W STEPS</b>	8'   10'6"
<b>HEIGHT/W AC</b>	11'6"
<b>FRESH TANK</b>	200 GAL.
<b>WASTE TANK</b>	1,000 GAL.
<b>WEIGHT</b>	11,450 LBS.
<b>AXLE TORSION</b>	(2) 7,000 LB.

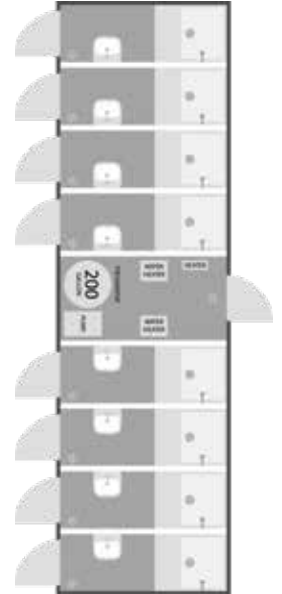

**28 FOOT | 8 DOOR**

<b>NO. OF STATIONS</b>	8
<b>LENGTH/W TONGUE</b>	28'   32'
<b>WIDTH/W STEPS</b>	8'6"   10'6"
<b>HEIGHT/W AC</b>	11'6"
<b>FRESH TANK</b>	200 GAL.
<b>WASTE TANK</b>	1,000 GAL.
<b>WEIGHT</b>	13,000 LBS.
<b>AXLE TORSION</b>	(2) 7,000 LB.

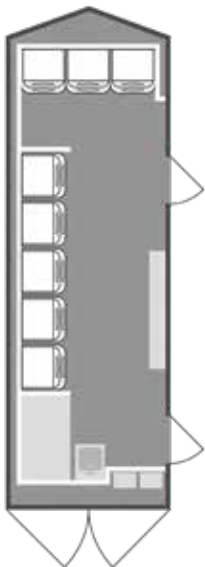

## SPECIALTY MODEL

**24 FOOT | LAUNDRY**

<b>NO. OF STATIONS</b>	8
<b>LENGTH/W TONGUE</b>	24'   31'
<b>WIDTH/W STEPS</b>	8'   10'6"
<b>HEIGHT/W AC</b>	11'8"
<b>FRESH TANK</b>	CONNECTION
<b>WASTE TANK</b>	CONNECTION
<b>WEIGHT</b>	3,200 LBS.
<b>AXLE TORSION</b>	(2) 7,000 LB.



# pri•va•cy

1. the state or condition of being free from being observed or disturbed by other people.



## 8-D SHOWER SUITE

The Satellite Suites 8-Station Flex shower trailer offers you and your customer's unequaled flexibility as well as many unique features. It can be configured for male/female use in a 4+4 or 2+6 floor plan, or as an 8 shower arrangement depending on gender requirements. And each shower stall has a changing area, shower and private lock.



REV  
ITEM #

Popular Suites Parts

50045	FAUCET METERED CHROME
51002	FAUCET REPAIR CARTRIDGE
50147	FENDER- S/AXLE 10 3/4x36x18
50328	Fender Light Amber/Red Rh
50329	Fender Light Amber/Red Lh
50044	PUMP-WATER
52268	FILTER-WATER PUMP
50433	WATER STRAINER 100 MESH
51788	WATER STRAINER BASE ONLY
50009	WATER HEATER 2.5G 110V
50407	Converter/Charger 80 Amp
50708	Converter/Charger 45 Amp
50309	A/C 13.5 BRISK II WHITE
50126	THERMOSTAT F/DUCTED A/C
50127	KIT SENSOR F/ DUCTED A/C
50128	KIT MUTIZONE F/DUCTED A/C
50310	HVAC COOL AIR DIVERTER F/DUCT
50313	KIT HEAT F/ DUCTED AC 10/14/18
50365	VENT 14" 12V CEILING
50366	VENT 14" GARNISH WHITE
50344	COVER MAXXAIR WHITE
50087	VENT ROOF STINK PIPE COVER
50007	TAPE- SIKA 2.75" WHT ROOF SEAL
50756	TOILET KIT JETS50M VAC WHT
51850	Seat And Cover F/Jets 50M
51857	JETS-VTS CONTROLLER VODE S6
55810	JETS ULTIMA C200 12V
51993	VACUUM TRANSMITTER
54605	Valve - CFD Valve 12VDC
50410	Switch- Flush F/Vacuum Toilet
50755	PUMP VACUUM SYSTEM 12VOLT 3 parts combined
56366	Jets Overhaul Kit
56367	Jets O-Ring Kit
52903	Jets- Vts Controller Vod 220volt
56667	Jets Ultimate C200-230-240/50
52923	Pump- Vac System Ultima 230v
54355	Toilet - Jets - Charm
55809	Toilet Seat and Cover f/Charm
53417	Transformer- 5000 Watts
50439	Kit Heat Kit Non Ducted
50438	Kit Adb Mech Un Ducted
50047	Urinal Toto 1.8 Gal/Flush
50046	Urinal Valve Complete
52145	Vacuum Pump For Urinal



# URINAL VALVE

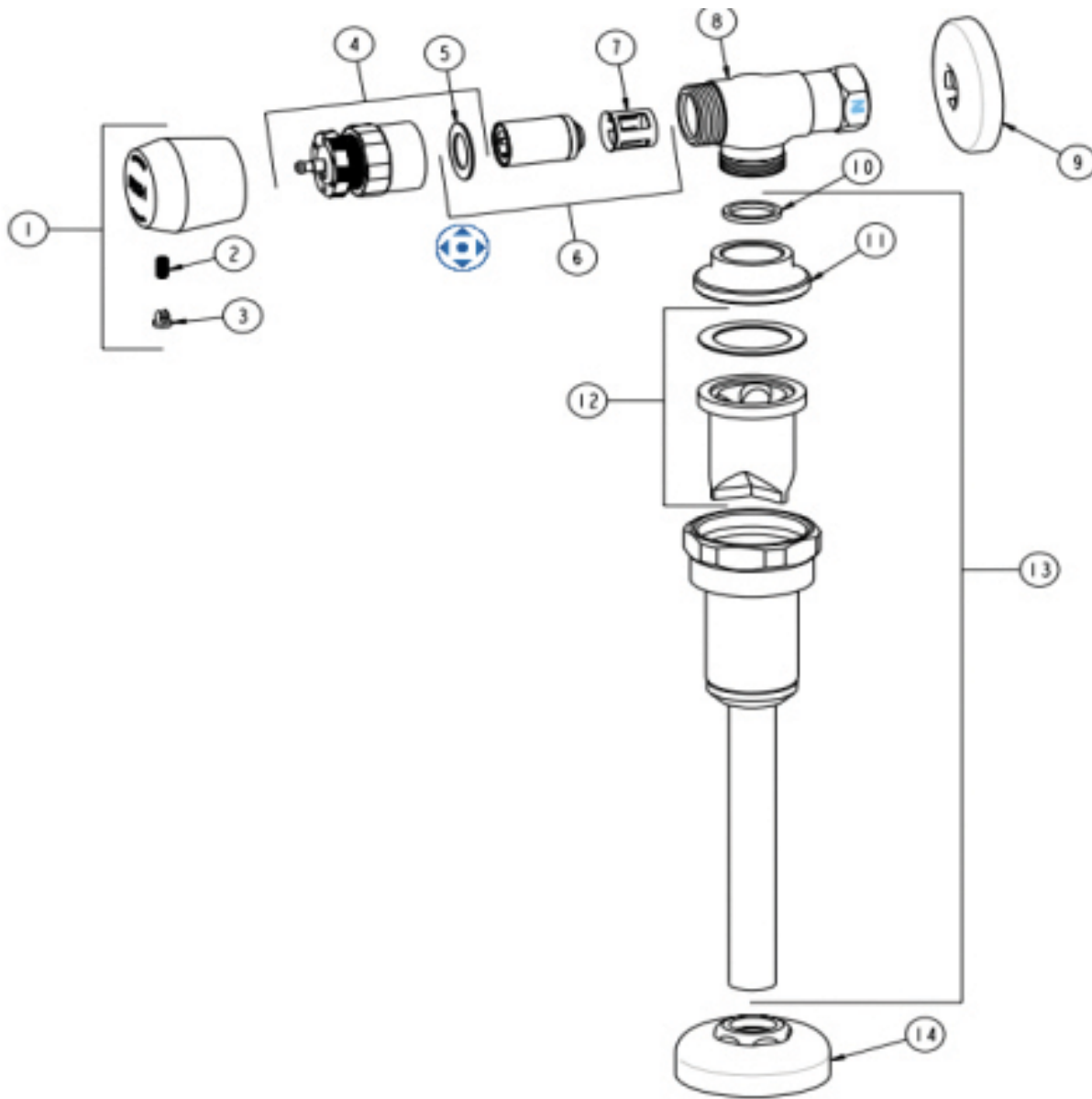

REV ITEM #	PART#	QPU	DESCRIPTION
	50046	1	URINAL VALVE COMPLETE
1		1	HANDLE PUSH BUTTON ASSEMBLY
2		1	
3		1	BUTTONS HOT AND COLD
4	52181	1	ACTUATOR ASSEMBLY
5		1	SEALING WASHER
6	51006	1	METERING VALVE REPAIR CARTRIDGE
7		1	FILTER
8		1	VALVE BODY (NOT SALEABLE)
9		1	WALL FLANGE
10		1	GASKET
11		1	ADAPTOR
12		1	UNINAL V.8 REPAIR KIT
13	52145	1	UNINAL VALVE VACUUM BREAKER
14		1	FLANGE ASSEMBLY PRE-PACK

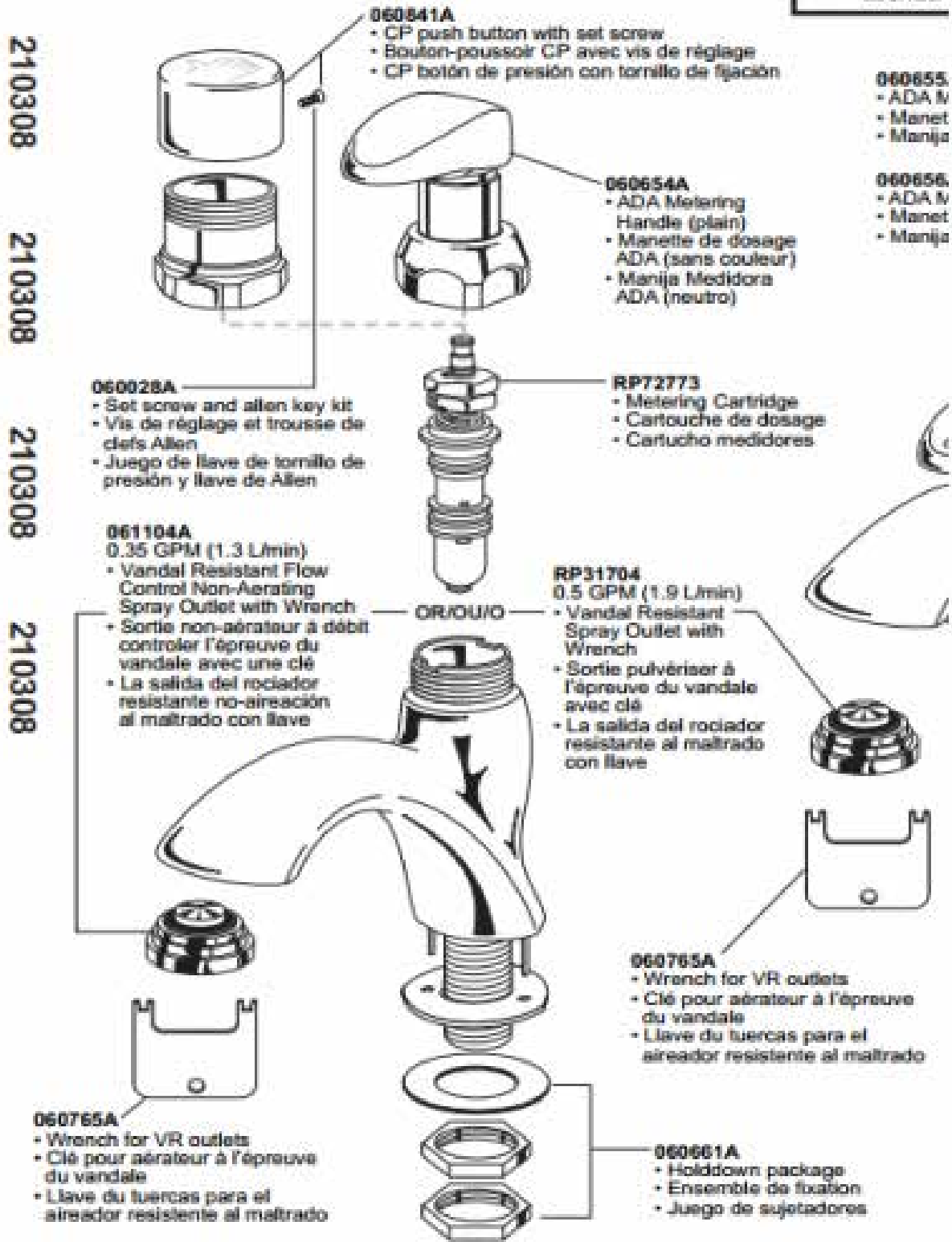

PART#	QPU	DESCRIPTION
50045	1	FAUCET METERED CHROM
51002	1	METERING CARTRIDGE
51276	1	FAUCET .5 GPM AERATOR KIT

## AQUA MAGIC STYLE II

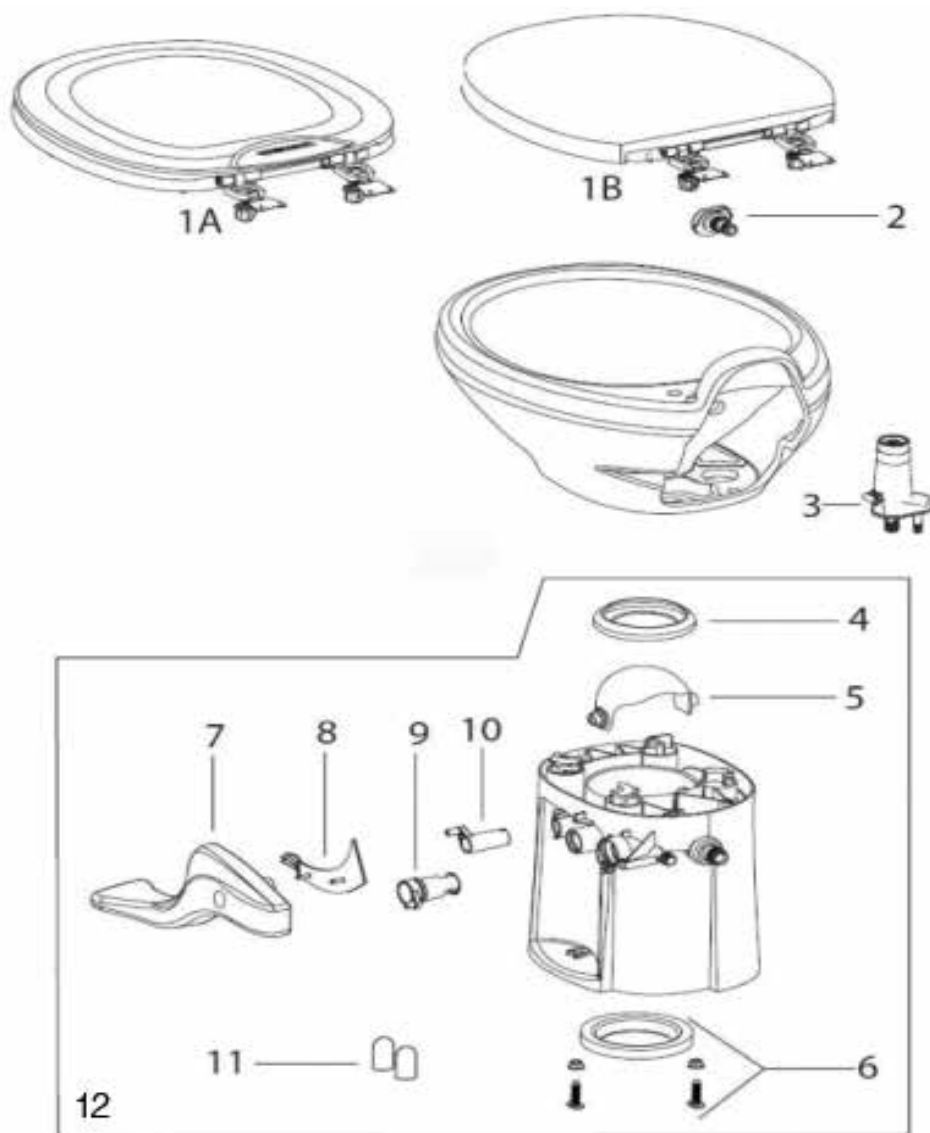

ITEM #	PART#	QPU	DESCRIPTION
	50406	1	TOILET STILE II HG WHITE
1B	50048		SEAT F/RESIDENTIAL TOILET
2			NOZZLE
3	51853	1	TOILET VACUUM BREAKER THETFORD
4	50715		TOILET WASTE BALL SEAL KIT
6	50712		TOILET CLOSET SEAL KIT
7	51630		TOILET PEDAL REPLACEMENT KIT
8			PEDAL COVER INSERT WHITE
9	50714		TOILET WATER VALVE KIT
11			BOLT CAP WHITE
12	50219	1	TOILET BASE REPL/H/WHITE

<b>PART#</b>	<b>QPU</b>	<b>DESCRIPTION</b>
50047	EA	URINAL TOTO 1.8 GAL/FLUSH
50046	EA	URINAL VALVE COMPLETE
51006	EA	URINAL VALVE REPAIR CARTRIDGE
52145	EA	VACUUM PUMP FOR URINAL
50707	EA	KNOB- SUITE F/URINAL FAUCET
50048	EA	TOILET SEAT AND CVR WHT
51630	EA	TOILET PEDAL REPLACEMENT KIT
50044	EA	PUMP-WATER
52268	EA	FILTER-WATER PUMP
50944	EA	PUMP 3/4 HP TANKLESS
50433	EA	WATER STRAINER 100 MESH
51788	EA	WATER STRAINER BASE ONLY
50794	EA	WATER HEATER TANKLESS
50009	EA	WATER HEATER 2.5G 110V
50417	EA	WATER HEATER 6G AOSMITH
50708	EA	CONVERTER/CHARGER 45 AMP
50309	EA	A/C 13.5 BRISK II WHITE
50126	EA	THERMOSTAT F/DUCTED A/C
50127	EA	KIT SENSOR F/ DUCTED A/C
50128	EA	KIT MUTIZONE F/DUCTED A/C
50310	EA	HVAC COOL AIR DIVERTER F/DUCT
50313	EA	KIT HEAT F/ DUCTED AC 10/14/18
50438	EA	KIT ADB MECH UN DUCTED
50439	EA	KIT HEAT KIT NON-DUCTED
50365	EA	VENT 14" 12V CEILING
50366	EA	VENT 14" GARNISH WHT
50888	EA	VENT- SUITE 14" NON-POWERED
50895	EA	VENT- SUITE 12V HIGH FLOW WHT
50344	EA	COVER MAXXAIR WHITE
50087	EA	VENT ROOF STINK PIPE COVER
50007	FT	TAPE- SIKA 2.75" WHT ROOF SEAL
52164	FT	BUTYL TAPE-1/8X3/4X30'
50084	EA	STEP-NON SLIP RV STYLE 24" <small>_BOTTOM TWO STEPS</small>
50756	EA	TOILET KIT JETS50M VAC WHT
51850	EA	SEAT AND COVER FOR JETS TOILET
51857	EA	JETS-VTS CONTROLLER VODE S6
50755	EA	PUMP VACUUM SYSTEM 12VOLT
51993	EA	VACUUM TRANSMITTER
50971	EA	SIGN GENDER UNISEX BLK
50424	EA	SIGN GENDER MALE BLK
50425	EA	SIGN GENDER FEMALE BLK

## ADDITIONAL PARTS

PART#	QPU	DESCRIPTION
50014	EA	DISPENSER SOAP STNLS
50015	EA	DISPENSER- SANITARY NAPKIN
50045	EA	FAUCET METERED CHROME - DELTA
50158	EA	STEP ASSY 42"
50217	EA	JACK 7K PIPE MOUNT
50365	EA	VENT 14" 12V CEILING
50406	EA	TOILET STILE II HG WHITE
50417	EA	WATER HEATER 6G AOSMITH
50433	EA	WATER STRAINER 100 MESH
50438	EA	KIT ADB MECH UN DUCTED
50439	EA	KIT HEAT KIT NON DUCTED
50712	EA	TOILET CLOSET SEAL KIT
50714	EA	TOILET WATER VALVE KIT
50756	EA	TOILET KIT JETS50M VAC
50804	EA	DISPENSER P.TWL.KEY'LS
50921	EA	DISPENSER DBL RL TP NL
50954	EA	STEP ASSY 32"
51002	EA	FAUCET REPAIR CARTRIDGE
51006	EA	URINAL VALVE REPAIR CARTRIDGE
51256	EA	JACK F/ SLIDING STEPS
51276	EA	FAUCET .5 GPM AERATOR KIT
51788	EA	WATER STRAINER BASE ONLY
51850	EA	SEAT AND COVER FOR JETS TOILET
53733	EA	STEP - 24" RV TOP PLATFORM
54285	EA	TOILET KIT JETS JADE
54355	EA	TOILET - JETS - CHARM
54368	EA	FAUCET - DELTA PUSH HANDLE